

State of S^c Carolina

Pursuant to a warrant from John Thomas Esq. Com^r of Locations Dated 26th Sept. 1786 I have admeasured and laid out unto Jeremiah Walker a tract of 540 acres of land in 96 District, Spartanburg County, on the branches of Lawson's fork & fairforest creek, and hath such shape, Marks, buttresses and boundings as the above Plat Represents, Survey, 27th Oct. 1786,

Jeppé Connell Esq.

Recorded for Col. Michl. Richardson, Robert H. Hughes & Co. the 6th febr'y. 1787.

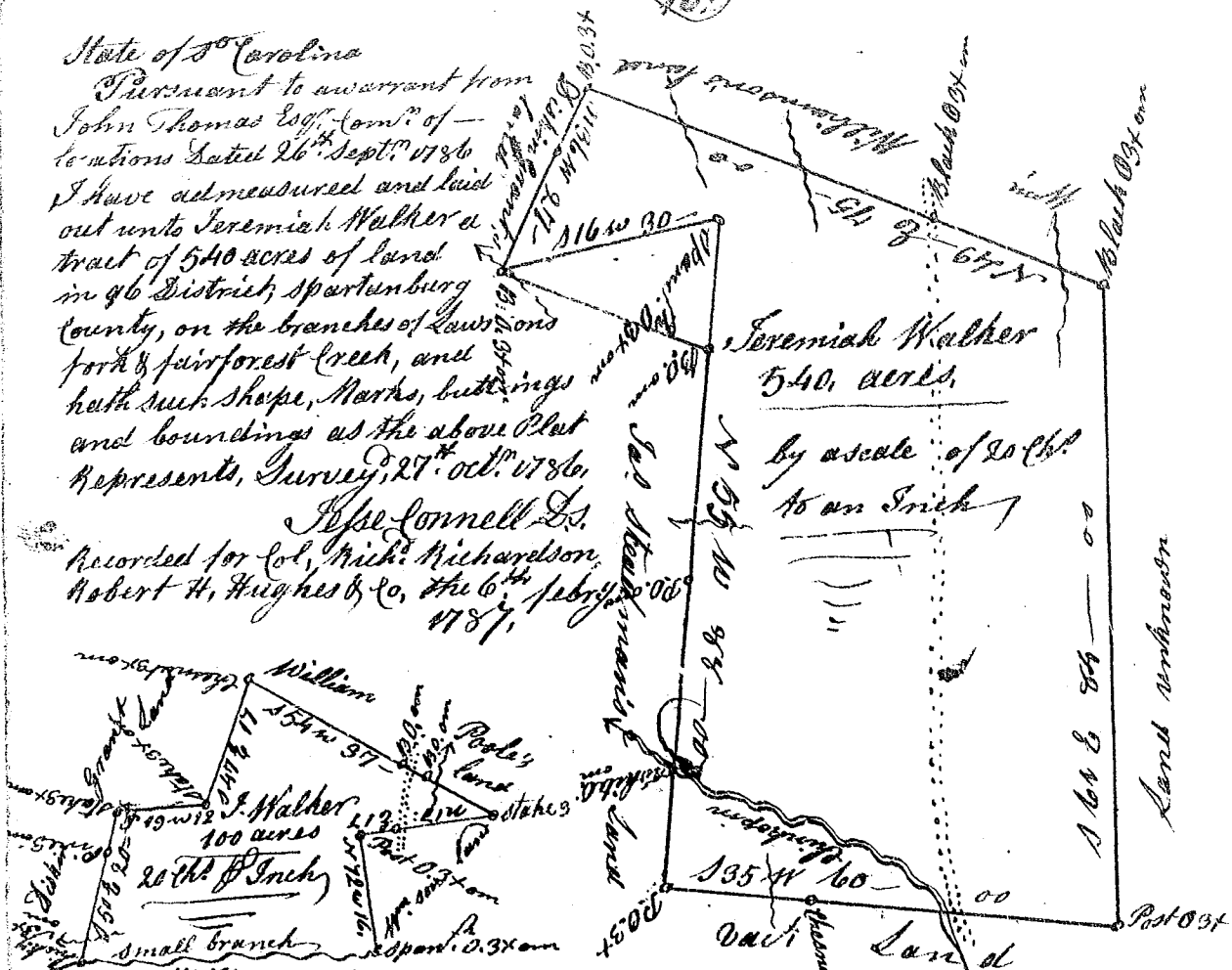

State of S^c Carolina, Pursuant to a warrant from John Thomas Esq. Com^r of Locations Dated 26. Sept. 1786, I have admeasured & laid out unto Jeremiah Walker a tract of 100 acres of land in ninety six District on the branches of Lawson's fork and fairforest, in Spartanburg County, and hath such shape and Marks as the above Plat Represents, Survey, 27th Oct. 1786, Jeppé Connell Esq. Recorded for Col. Michl. Richardson, Robt. H. Hughes & Co. the 6th febr'y. 1787.

State of S^c Carolina Pursuant to a warrant from John Thomas Esq. Com^r of Locations, I have admeasured and laid out unto Solomon Crocker a tract of 536 acres of land, in 96 district, on hickland creek a branch of Pacolet, bounded E. on the big survey N on Lee's land, W. on Marshalls & Dickson's land, S. on Wm. Crocker's land, and hath such shape & Marks as the above Plat Represents, Survey, 2nd Oct. 1786, Cardway H. Lee D^s. Recorded for Col. Michl. Richardson, Robt. H. Hughes & Co. the 6th febr'y. 1787.

