

State of S. Carolina

Pursuant to a  
Warrant from John Thomas  
Esq. I have admeas-  
ured & laid out unto Christo-  
pher Ruff a tract of  
One Hundred & fifteen  
Acres of land. Situate in

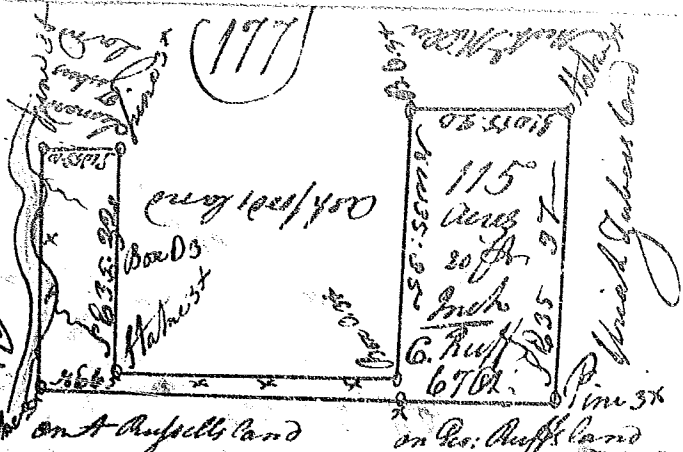

on Ruff's land  
of District on Broad River. & hath such form marks & buttings  
and bounding as the above plat represents.  
Recorded the 26<sup>th</sup> Feb<sup>y</sup> 1787 Surveyed the 11<sup>th</sup> Jan<sup>y</sup> 1787

Pursuant to a warrant from  
John Thomas Esquire I have  
admeasured & laid out unto  
Christian Ruff a tract of  
40 Acres of land Situate in

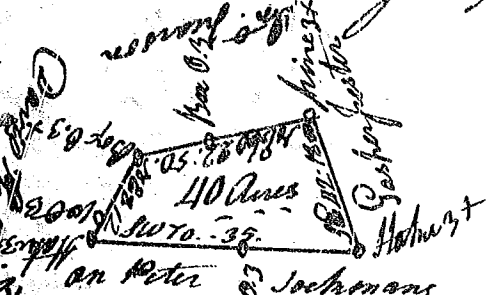

of District. on the waters of Cannon  
Creek. & hath  
such form marks & buttings & bounding as the above  
plat represents. Surveyed the 17<sup>th</sup> Jan<sup>y</sup> 1787

Recorded the 26<sup>th</sup> Feb<sup>y</sup> 1787  
Pursuant to a warrant  
from John Thomas Esq. I have

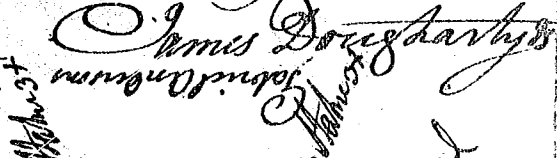

I have admeasured & laid out unto  
Christian Ruff a tract of 75 Acres  
of land Situate in of District on  
the waters of second Creek a branch  
of Broad River of hath such form marks & buttings & bounding  
as the above plat represents.  
Surveyed the 5<sup>th</sup> Jan<sup>y</sup> 1787

Recorded the 26<sup>th</sup> Feb<sup>y</sup> 1787  
I have admeasured and laid out unto Christian Ruff a  
tract of 14 Acres of land in of District on the waters of second  
Creek a branch of Broad River of hath such form  
marks & buttings as the above plat represents  
Surveyed the 14<sup>th</sup> Jan<sup>y</sup> 1787

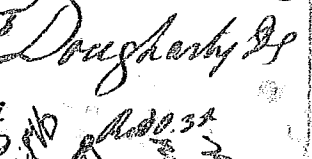

Recorded the 26<sup>th</sup> Feb<sup>y</sup> 1787  
Del<sup>d</sup> the 4<sup>th</sup> above heats to be Peter Ruff