

State of S. Carolina -
 Pursuant to a warrant
 from John Thomas Esq. Clk. for
 96 District N. of S. Carolina. I have
 assured and laid out unto
 William Becham, a tract
 of 233 acres of land. Situated
 in the Dist. aforesaid on Broad
 River. & hath such form
 marks, & cuttings of its boundaries
 as the above Plot Represents

Surveyed the 3rd April 1787
 Recorded 15 April 1787
 Lewis D.

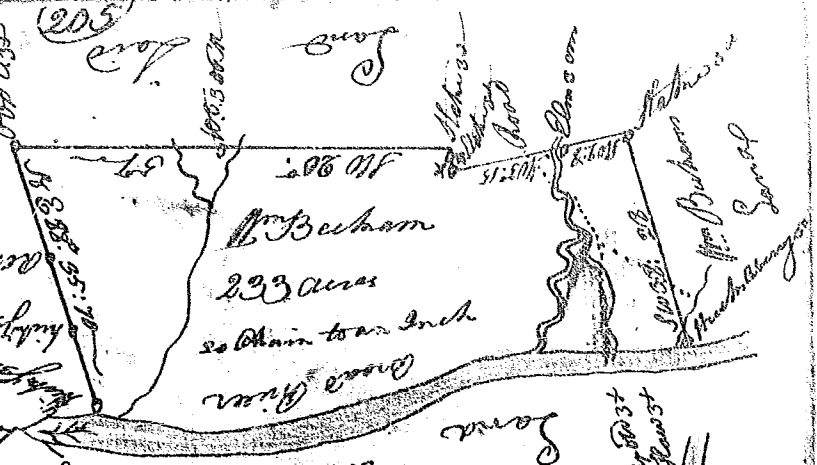

State of S. Carolina -
 Pursuant to a warrant from
 John Thomas Esq. Clk. I have assured
 & laid out unto W. Becham a tract
 of land containing one hundred and
 fifty eight a/c. Situated in 96 District on
 Broad River of hath such form and
 marks, & cuttings of its boundaries
 as the above Plot Represents

Surveyed the 3rd April 1787
 Recorded 15 April 1787
 Lewis D.

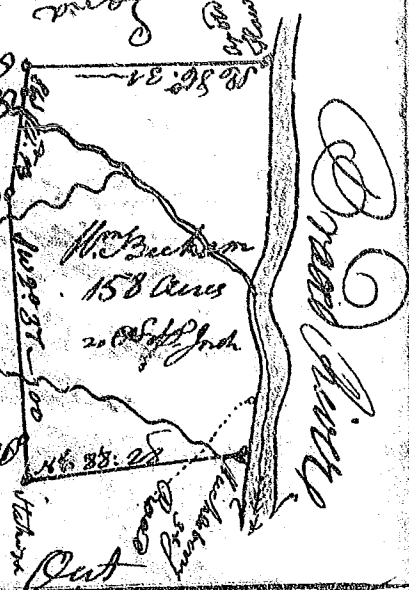

State of S. Carolina
 Pursuant to a warrant
 from John Thomas Esq. Clk.
 of locations, I have assured
 & laid out unto Lewis Hogg
 a tract of 300 acres
 of land in 96 Dist.
 on Hogg's branch of
 Enoree River, and
 hath such shape and
 marks as the above
 Plot Represents.

Surveyed the 1st March 1787.
 Jas. Dougherty
 Del.

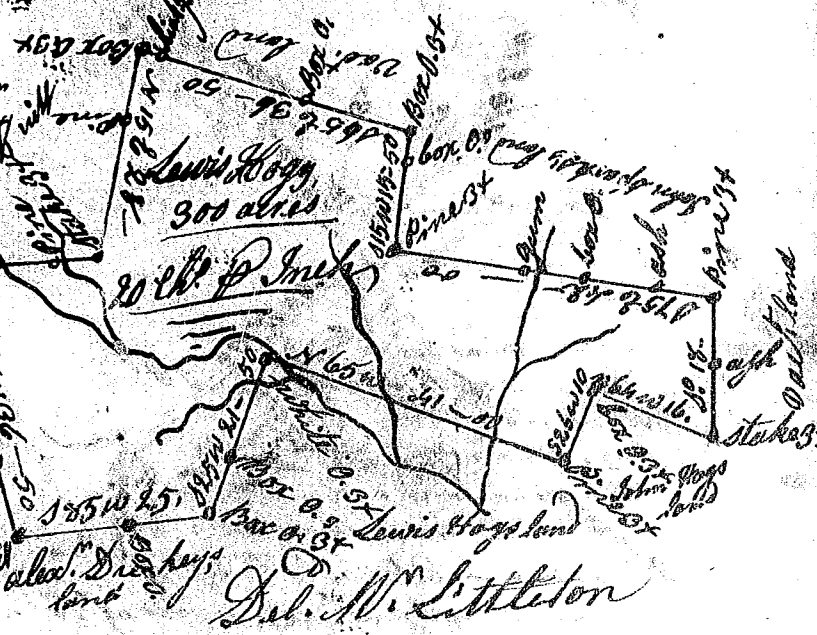

Recorded 20 April 1787