

State of Carolina,

Pursuant to a warrant from Ex<sup>co</sup> Com<sup>rs</sup> of locations, I have admeasured and laid out unto James Smith a tract of 310 acres of land in 16 District, on the branches of Tappan River, and hath such shape form & marks, buttings & boundings as the above flat represents, Surveyed 19<sup>th</sup> Oct. 1787, p<sup>r</sup> Charles Simms Esq.

Recorded 17<sup>th</sup> Nov. 1787 Del. July

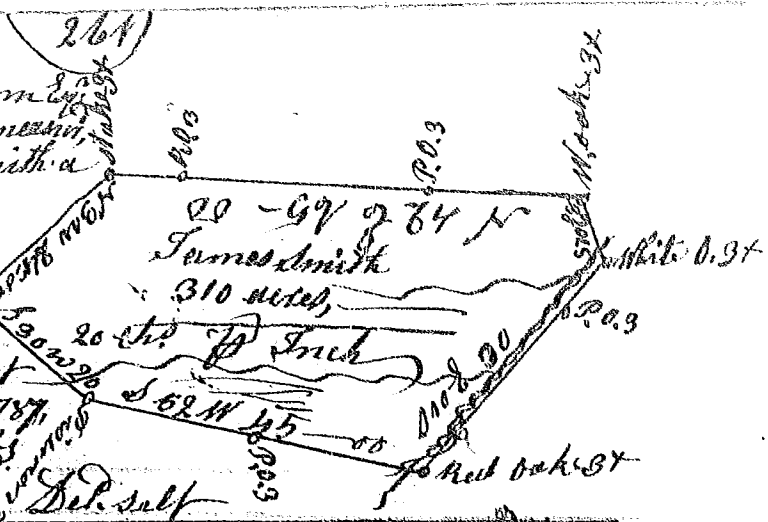

South Carolina Pursuant to a warrant from John Thomas Com<sup>rs</sup> of locations N<sup>o</sup> Saluda, I have admeasured and laid out unto Thomas Aikens a tract of 1000 acres of land, in the late Purches Made from the Cherokee Indians, in Greenville County on the branches of a middle fork of Saluda River, Bounding N<sup>o</sup> & on land of said Aikens all other sides Vacant, Surveyed 14<sup>th</sup> Nov. 1787, Robt Prince Esq.

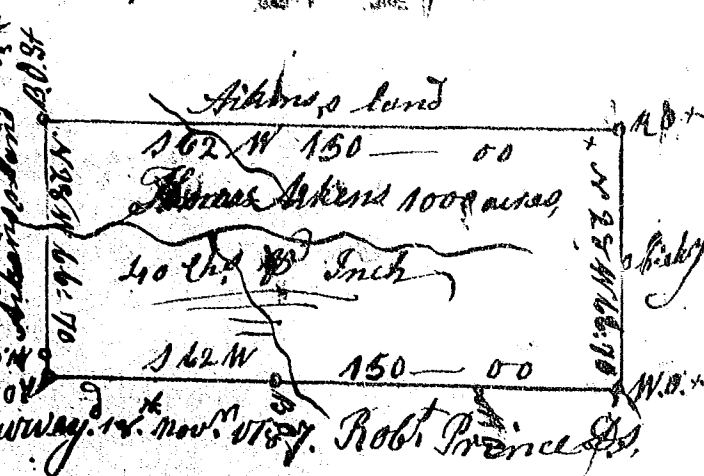

South Carolina Pursuant to a warrant from John Thomas Com<sup>rs</sup> of Loc<sup>ns</sup> N<sup>o</sup> Saluda, I have admeasured & laid out unto Thos Aikens a tract of 1000 acres, in the late Purches from the Cherokee Indians, in Greenville County, on the middle fork of Saluda, bounding N<sup>o</sup> & on 1/2 North Littleton, all other sides Vacant, and hath such shape form and marks as the above flat represents, Surveyed 19<sup>th</sup> Nov. 1787

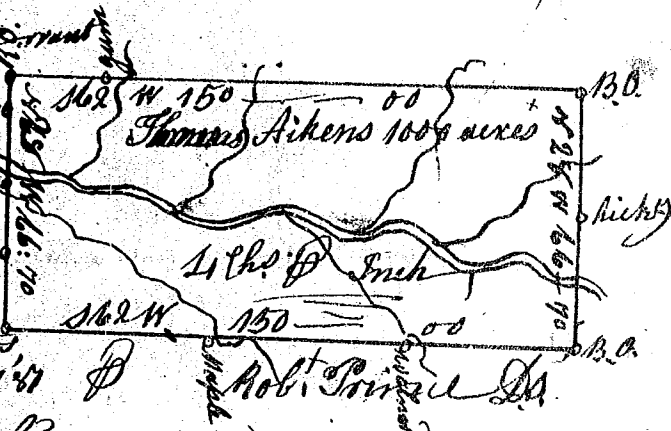

Recorded 18<sup>th</sup> Nov. 1787

Pursuant to a warrant from John Thomas Esq. N<sup>o</sup> Saluda, I have admeasured & laid out unto Thomas Aikens a tract of 1000 acres of land, situated in Greenville County on the branches of the Middle fork of Saluda River, Bounding N<sup>o</sup> & on Thomas Aikens, all other sides vacant and hath such form & marks as the above flat represents, Surveyed the 17<sup>th</sup> Nov. 1787

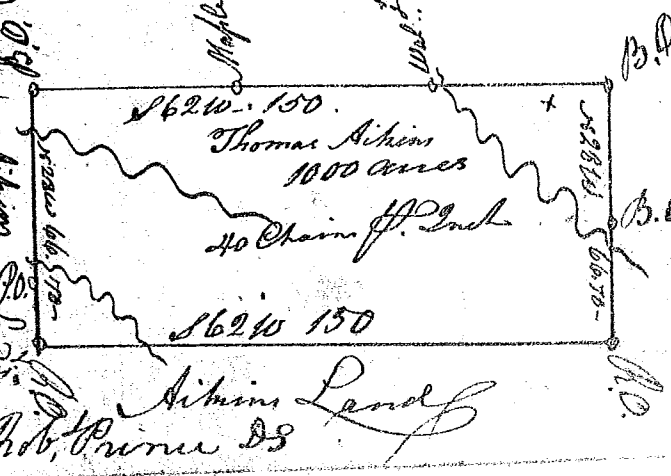

Recorded 20<sup>th</sup> Nov. 1787

Aikens Land Robt Prince Esq