

South Carolina Pursuant to a warrant from John Thomas Esq. Comm. of Saluda I have admeasured & laid out unto Thomas Aikins a tract of 750 acres of land. Situate in the late purchase from the Cherokee Indians in Greenville County on Gap Creek of Saluda River bounding N.E. & S.E. on land of P. Aikins all other sides vacant land and hath set form & marks as the above plat represents Surveyed this 10th day of November 1787 By Robert Princes Esq.

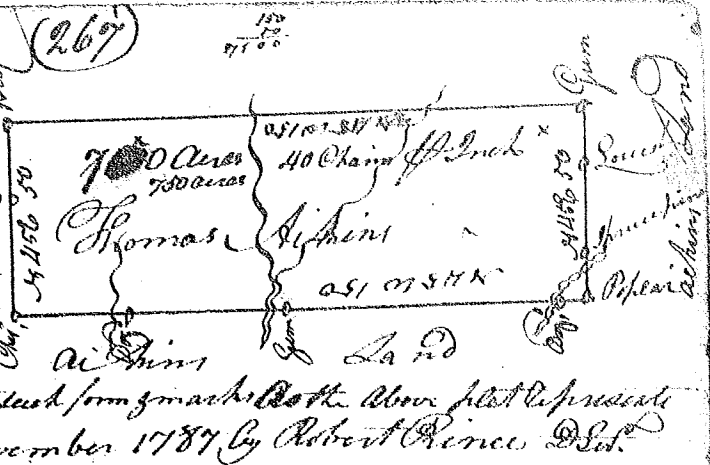

South Carolina Pursuant to a warrant from John Thomas Esq. Comm. of Saluda I have admeasured & laid out unto Thomas Aikins a tract of 750 acres of land. Situate in the late purchase from the Cherokee Indians in Greenville County on Gap Creek of Saluda River bounding N.E. & S.E. on land of the P. Aikins all other sides vacant land and hath set form and marks as the above plat represents Surveyed the 10th Nov. 1787 Robert Princes Esq.

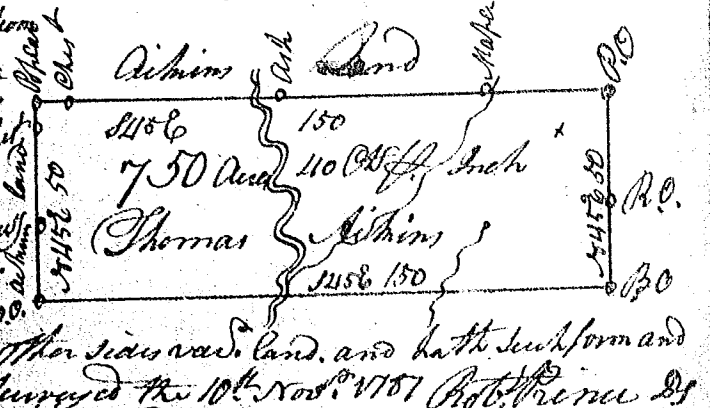

South Carolina Pursuant to a warrant from John Thomas Esq. Esq. of Saluda I have admeasured & laid out unto Thomas Aikins a tract of 750 acres of land. Situate in the late purchase made from the Cherokee Indians in Greenville County on Gap Creek of Saluda River bounding N.E. & S.E. on P. Aikins all other sides vacant & hath set form & marks as the above plat represents Surveyed the 10th Nov. 1787 Robert Princes Esq.

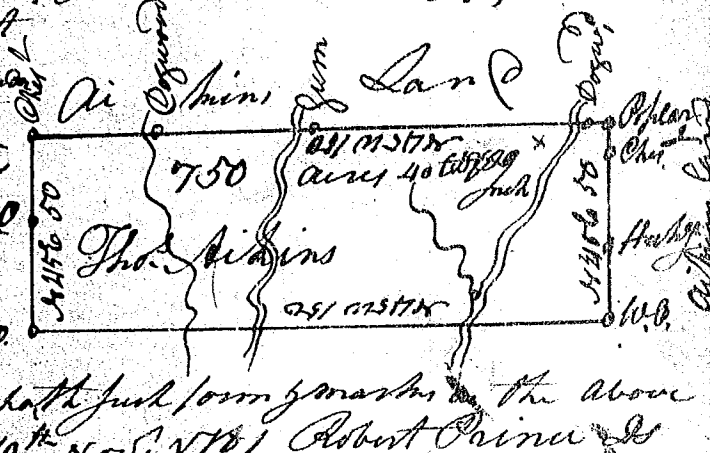

South Carolina Pursuant to a warrant from John Thomas Esq. Comm. of Locations of Saluda I have admeasured & laid out unto Thomas Aikins a tract of land containing 500 acres. Situate in the late purchase made from the Cherokee Indians in Greenville County on the waters of Gap Creek of the Middle fork of Saluda River bounding N. & W. on land of the P. Aikins all other sides vacant land and hath set form & marks as the above plat represents Surveyed the 10th Nov. 1787

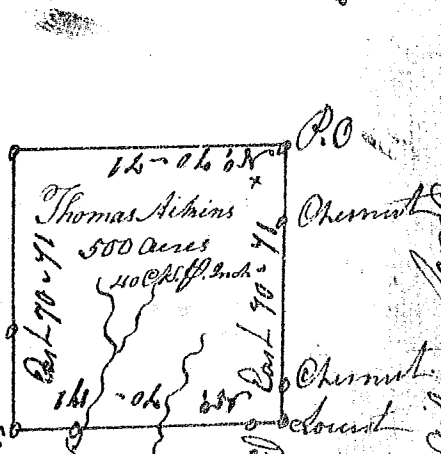

Reviewed the above plats this 20th Nov. 1787 Robert Princes Esq.