

State South Carolina

In pursuance to a warrant  
 from John Thomas Court  
 for Land in the District  
 of Rich. for 200 Acres  
 Dated the 5<sup>th</sup> February 1788

I have administered said  
 out into Rich. Seaco a  
 Tract of Two Hundred & fifty  
 Acres of Land Situate in said  
 District in Greenville County  
 on both sides Buckhorn  
 Branch of Enoree River all  
 sides on Vacant Land and hath  
 such shape and marks as above  
 That represent

Surveyed the 2<sup>nd</sup> Day of April 1788  
 Recorded the 3<sup>rd</sup> May 1788 L<sup>th</sup> Whitner 24<sup>th</sup> 1788

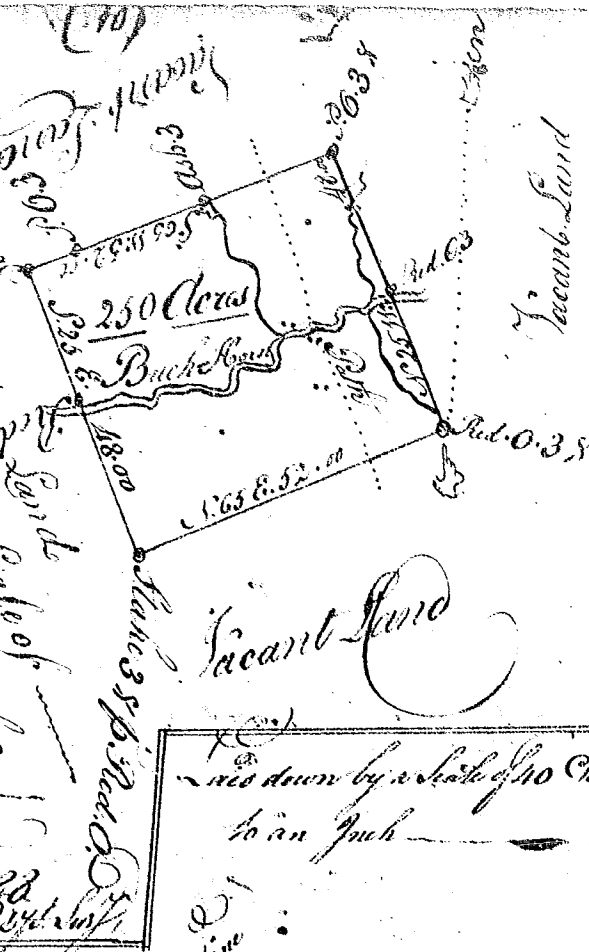

is down by a stake of 10 Chain  
 to an Inch

South Carolina

In pursuance to a warrant from  
 John Thomas Court, Sheriff and I have administered  
 out into Rich. Seaco a Tract of 778 Acres  
 Situate in 96 District on the South side  
 of Broad River on the Branches of  
 Peachtree and hath such shape and  
 marks as the above That represent

Surveyed the 10<sup>th</sup> of March 1788  
 Recorded the 6<sup>th</sup> of May 1788 and  
 Shewed to John Thomas Sheriff

