

(75)

South Carolina, Pursuant to a warrant from John Thomas Esq. Comr. of loc. N. Saluda Dated 11. Jan^y 1787, I have admeasured and laid out unto John [Name] a tract of forty acres of land, on the waters of the Beaver-dam a branch of Saluda, and hath such Shape, Marks, buttings & bounding, as the above Plat represents,
 Surveyed 27. Jan^y 1787, Tho^s. W. Waters Esq.
 Recorded 23. April 1789. Del. self,



State of South Carolina Pursuant to a warrant from John Thomas Esq. Comr. of loc. N. Saluda, Dated 11. Jan^y 1787, I have admeasured & laid out unto Andrew Barrett a tract of forty five acres of land, on the waters of bush-river: a branch of Saluda and hath such Shape, Marks, buttings & bounding, as the above Plat represents, - Surveyed 27. Jan^y 1787, Tho^s. W. Waters Esq.
 Recorded 23. April 1789, Del. self,



South Carolina Pursuant to a warrant from John Esq. Comr. of loc. 96 District N. Saluda, I have admeasured and laid out unto John Roney a tract of 199 acres of land on the waters of little river, on Simons Creek, bounded by land held by Gilman Winn, on line running N 30 E. and on line running S 51 E on Mr. Hancocks land, a line running S 66 W, and by line running S 53 E on Edmond Drakes land, a line running S 31 W on Thomas Wadsworths land, a line N 49 W on Joseph Blackadays land, - and hath such Shape, Marks, buttings and bounding, as the above Plat represents,
 Surveyed 17. April 1789, Tho^s. Hunter Esq.
 Recorded 23. April 1789. Del. self,

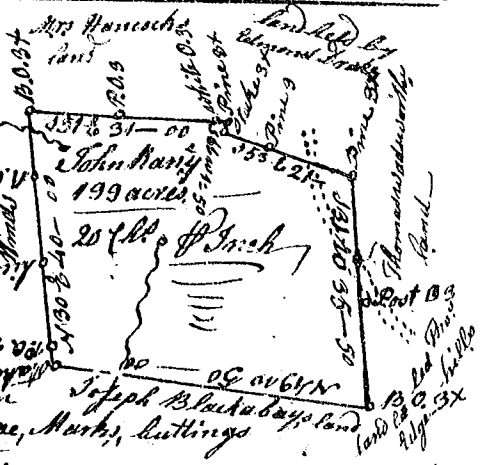

South Carolina, Pursuant to a warrant from John Thomas Esq. Commissioner of locations, Dated 30. March 1789, I have admeasured and laid out unto Henry Machan Wood a tract of one hundred & one acres of land, in Greenville County on the branches of the N. fork of Saluda river, bounded by lines running N. E. by David Mc-Lays land, S. E. N. W. S. W. and S. E. by Dacort. land & Mc-Lays land, N. W. by Mary Whites land North, N. W. S. W. N. W. & N. E. by Daniel Kelly & Henry Machan Woods lands, and hath such Shape & Marks as the above Plat represents, Surveyed 21. April 1789,
 Recorded 24. April 1789, Joseph Whitner Esq.

