

(179)  
 State of N<sup>o</sup> Carolina Pursuant to a warrant from John Thomas Esq. Com<sup>r</sup>. of loc<sup>o</sup> N<sup>o</sup> 1<sup>o</sup> March 1789, I have admeasured & laid out unto Benjamin Morgan a tract of one hundred and twenty seven acres of land in 9<sup>th</sup> District, on waters of Indian Creek of Broad river, bounding N.E. Part on John Berry's land, on Sam<sup>l</sup> Teague's land, S.E. on Margaret Dixons land, S.W. on John Johnsons land, and hath such shape and Marks as the above Plat represents, survey 1<sup>st</sup> March 1789, Recorded 20. May 1789, Del. S. Stags To Wright Esq

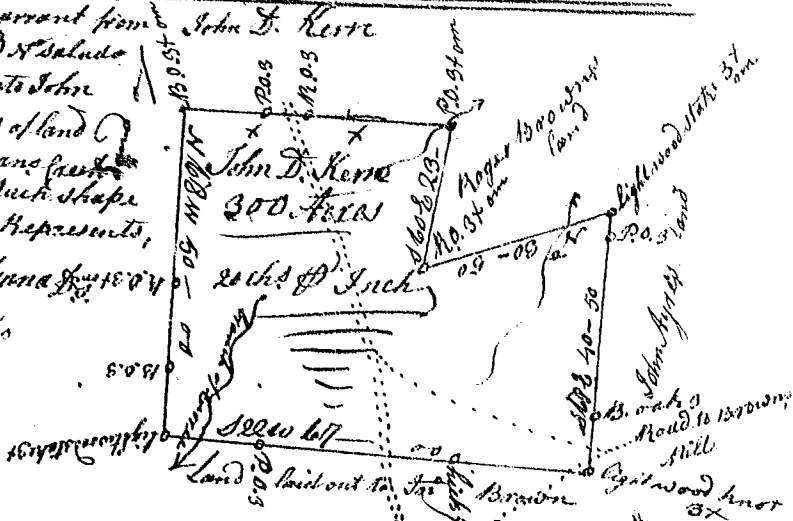

to Carolina Pursuant to a warrant from John Thomas Esq. Com<sup>r</sup>. of loc<sup>o</sup> N<sup>o</sup> Saluda I have admeasured & laid out unto John Daniel Kern a tract of 300 acres of land on the branches of Surree & Duncans creeks in Laurens County, having such shape and Marks as the above Plat represents, Survey 5<sup>th</sup> May 1789, Rob<sup>t</sup> Hanna Esq. Recorded 25. May 1789, Del. F. Bobo



State of S<sup>o</sup> Carolina Pursuant to a warrant from John Thomas Esq. Com<sup>r</sup>. of loc<sup>o</sup> N<sup>o</sup> Saluda, I have admeasured and laid out unto John Gasser a tract of one hundred & seventy acres of land, on the S<sup>o</sup> fork of Duncans Creek in Laurens County, having such shape & Marks as the above Plat represents, Survey 3<sup>rd</sup> April 1789, Rob<sup>t</sup> Hanna Esq. Recorded the 25. May 1789, Del. F. Bobo



State of S<sup>o</sup> Carolina Pursuant to a warrant from John Thomas Esq. Com<sup>r</sup>. of loc<sup>o</sup> N<sup>o</sup> Saluda I have admeasured & laid out unto John Ayres a tract of 100 acres of land on the Branches of Dilbeans Creek in Laurens County, having such shape & Marks as the Plat represents, Survey 26<sup>th</sup> March 1789, Rob<sup>t</sup> Hanna Esq. Recorded 25. May 1789, Del. F. Bobo,

