

South Carolina Pursuant to a warrant from John Thomas Esq. Comr. of Locations, 96 District N. Saluda I have admeasured & laid out unto John Lewis a tract of three hundred & sixty nine acres of land, on brush creeks water of heady river and hath such shape, marks, cuttings and Roundings as the above Plat represents. Surveyed 27 July 1789.

John Lewis D.S.

Recorded 23rd Sept. 1789

John Self

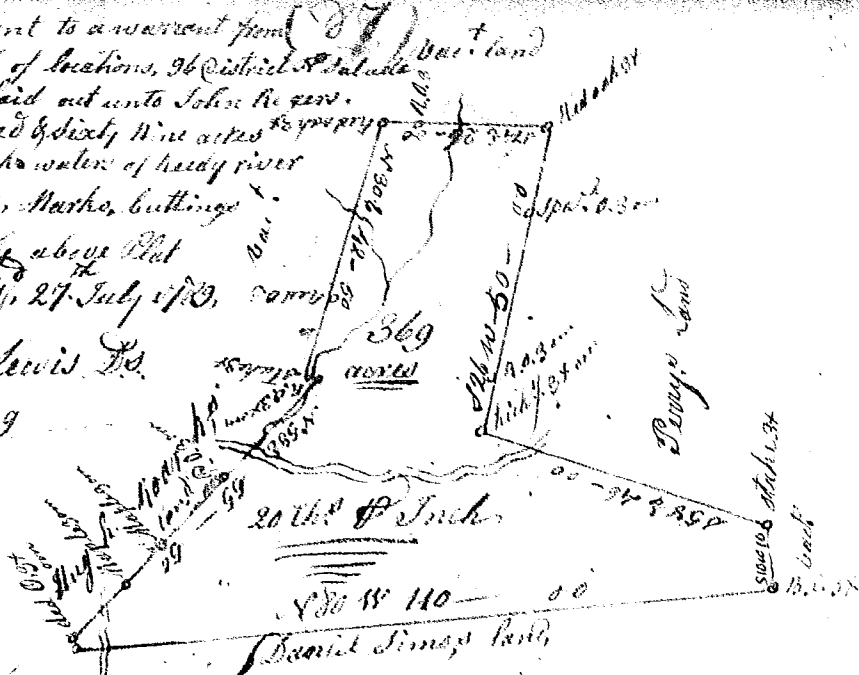

South Carolina Pursuant to a warrant from John Thomas, Esq. Comr. of loc. 96 District N. Saluda, I have admeasured and laid out unto James Pettys a tract of four hundred and ninety one acres of land, on both sides of a bottom, waters of broad river, running S. by E. on said Pettys land thence N. W. on said Pettys land, thence S. E. on running S. W. on each land, from thence to the beginning, and hath such shape & marks as the above Plat represents. Surveyed 25 July 1789.

James Pettys D.S.

Recorded 23rd Sept. 1789

James Pettys

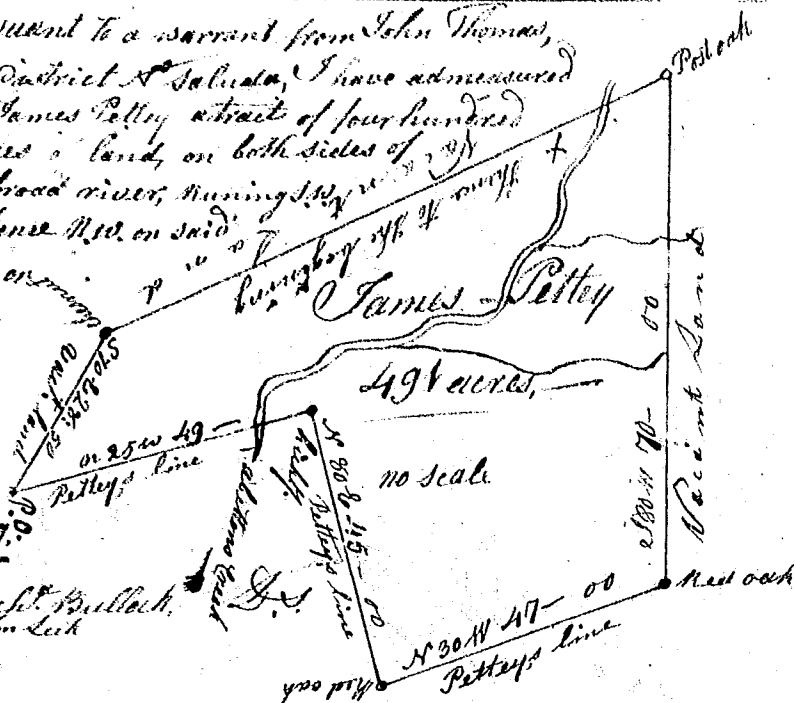

South Carolina Pursuant to a warrant from John Thomas Esq. Commissioner of Locations, in 96 District N. Saluda, I have admeasured and laid out unto Jonathan Popel a tract of three hundred & thirty seven acres of land, in said District on both sides of Buckhorn Creek a branch of Enoree river, in Greenville County bounding by a line running S. W. by Robert Prince, or vacant land, all other sides by vacant land, and hath such form & marks as the above Plat represents. Surveyed 4th Sept. 1789. Wm. D. Thomas D.S.

Recorded 9th Oct. 1789

