

South Carolina } Pursuant to a warrant from
 John Thomas Esq. Comm. Gen. in 6th Dist. 13th Decem^r 1789 I have admeasured and laid out unto John McKibbin a tract of sixty three acres Land in Ninety six Dist. on a branch of the creek waters of fair forest bounding by a line running N. W. by Land survey for George Cozoplygathes a line running S. W. by Land survey for John McCool all other side on unknown lands & hath such form and marks as the above plat represents

Surveyd 19th Decem^r 1789 by W. Gaston D.

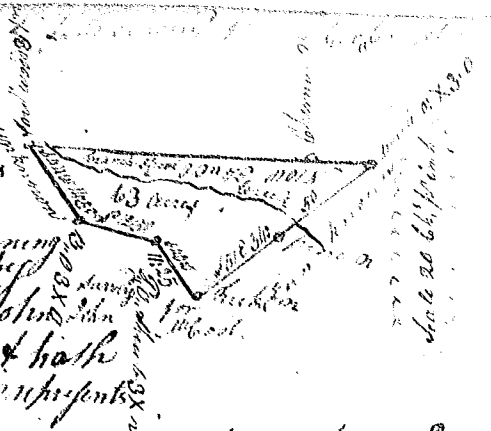

South Carolina, — Pursuant to a warrant from John Thomas Esq. Com. of 6th & 7th Side Saluda, Dated 15th Juny 1790. I have admeasured and laid out unto Joseph Reides a tract of fifty acres of land in Ninon County 96 Dist. on a small draft of fair forest creek waters of Sugar river, bounded by a line running S. 41 E. by land survey for Uriah Polk, by a line running S. 85 E. by a line running N. 88 E. & S. 85 E. by vacant land, by a line running N. 42 E. by John Bogans land, and hath such shape and marks as the above Plat represents

Surveyd 24th Feb^r 1790, J. Pearson D.
 Det. Maj. W. Junkin



South Carolina Pursuant to a warrant from John Thomas Esq. Com. of 6th Dist. Saluda, dated 10th Feb^r 1790. I have admeasured and laid out unto James Cook a tract of 251 acres of land in Ninon County on two small drafts of Timber-creek waters of Sugar River, bounded by a line running S. 84 E. by land survey for El. Cook, by a line S. E. by land survey for Moses Addison, by a line S. 112 E. & N. 88 E. by land survey for Henry Stillhouse, all other sides vacant, and hath such shape and marks as the above Plat represents,

Surveyd 13th Feb^r 1790, J. Pearson D.
 Recorded 21st Feb^r 1790, Det. Maj. W. Junkin

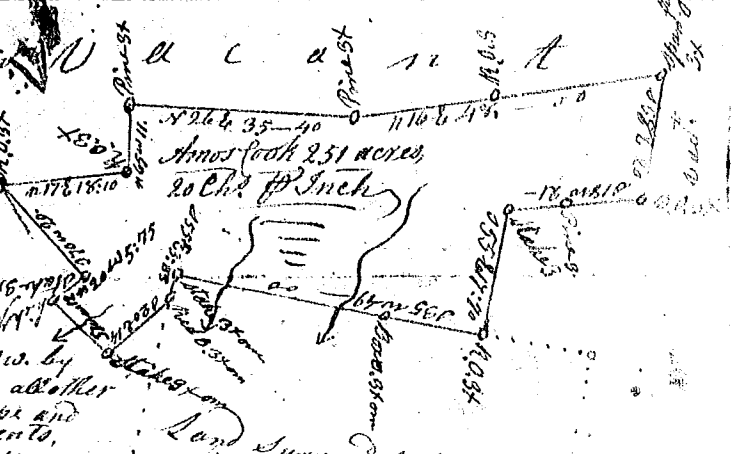

South Carolina Pursuant to a warrant from John Thomas Esq. Commissioner of locations in 6th District dated 24th July 1789, I have admeasured & laid out unto George Ruffel a tract of two hundred & sixteen acres of land in said district on both sides of Kemps branch waters of Enoree river, bounding N. ward by Absolom Farnes land, N. E. ward by Solomon Kemps land, S. ward by Uriah Conners land W. by William Ruffels land, and hath such shape form & marks as the above Plat represents, Surveyd 4th Aug^t 1789, John C. Hillpatrick D.
 Recorded 2^d March 1790, Det. Self

