

State of S^c Carolina Pursuant to a warrant

from John Thomas Esq. Com^{rs} of loc^{ns} 96 District
 N^o Saluda Dated the 1st Aug. 1790 I have admeasured and
 laid out unto Charter Nicols a tract of forty three acres of
 land in 96 District Laurens County on Cain Creek
 waters of Saluda river. Bounded by a line running N
 83 W 1/4 on land of Charter Nicols, and by a line S 50 W
 22 on John Nichey land, S 38 E Gray's land, N 51 E on salt
 = Spring John Cortley's land, N 30 W on land laid out for
 Samuel Weather's, and hath such shape form and
 Marks as the above Plat represents,
 Recorded 17th Nov^r 1790; Deid self Survey, 30 Aug. 1790, John Hunter Esq

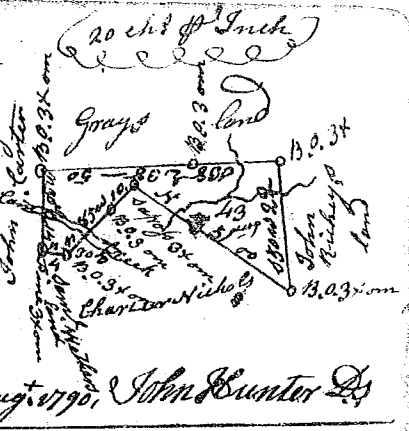

State of South Carolina Pursuant to a warrant

from John Thomas Esq. Com^{rs} of loc^{ns} 96 District
 N^o Saluda Dated 21st Sept^r 1790, I have admeasured
 and laid out unto Joseph Banner a tract of
 of Two hundred and eighty seven acres
 of land in said district on the waters
 of Banks Creek waters of Saluda
 Bounded by a line running S 42 E
 on Isaac land, and by line S 77 E
 25 ch^s on Polard's land
 and by line N 40 E 29 ch^s
 = 50 line N, N^o 25 E 14 on
 William Deary's land
 N 12 W 55 72 on George
 Neely's land, N 70 W 56
 = 50 on Joseph Holingsworth
 land and hath such form and Marks as the above Plat represents
 Recorded 20th Nov^r 1790 Deid. Charter Nicols Survey, 23rd Sept^r 1790, John Hunter Esq

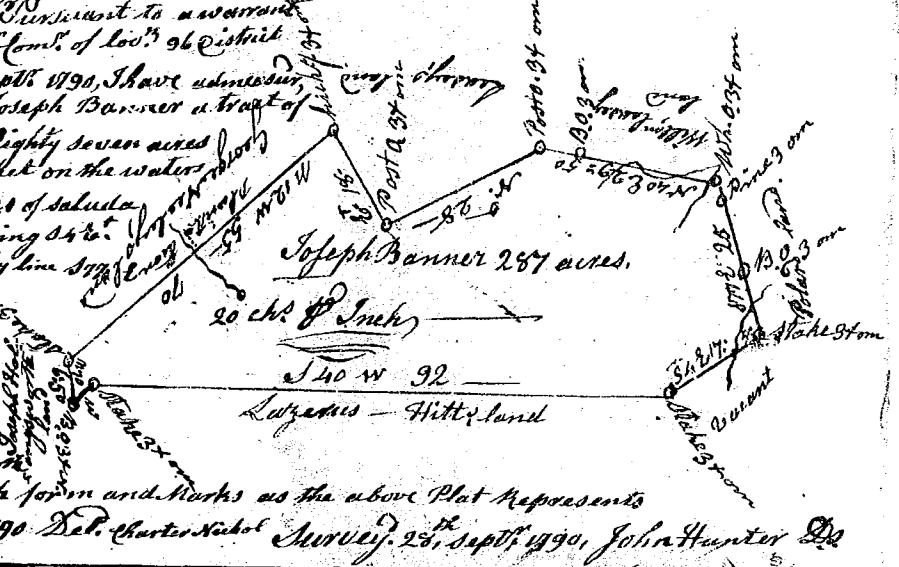

State of S^c Carolina Pursuant to a warrant from

John Thomas Esq. Com^{rs} of loc^{ns} 96 District N^o Saluda
 Dated 23rd Sept^r 1790, I have admeasured and laid out
 unto Patrick Rogers a tract of one hundred & twenty
 acres of land in said District on the waters of
 Banks Creek water of Saluda, Bounded by a line
 running S 80 W on Sandy Deal's, N 72 W 1/4 S 70 W on
 Frost's land, N 12 E 27 1/4 N 70 W 14 - 50 on George
 Neely's land, N 70 E 44 - 50 on Joseph Holingsworth
 land, S 12 E 14 on John Neely's land, and hath
 such shape and Marks as the above Plat
 represents. Survey, 24th Sept^r 1790
 Recorded 26th Nov^r 1790 Deid. Ch^r Nicols John Hunter Esq

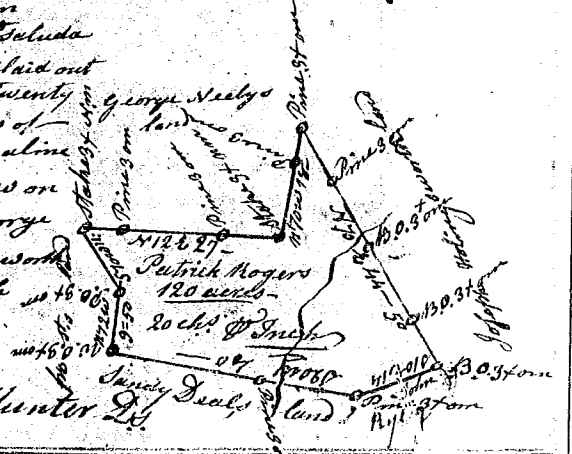

State of S^c Carolina Pursuant to a warrant from

John Thomas Esq. Com^{rs} of loc^{ns} N^o Saluda, I have
 admeasured and laid out unto William Stone a
 tract of Eighty acres of land on the Branches
 of Two Mile Creek in Spartanburg County
 having such shape, Marks, buttings and
 boundaries as the above Plat represents,
 Survey, 23rd Nov^r 1790,
 Recorded 15th Dec^r 1790 Rob^t Hanna, Esq
 Deid. Self,

