

South Carolina Pursuant to warrant (119)  
 Laurens County from John Thomas Esq. Comr.  
 of locations in 26 District 87

Saluda dated 7<sup>th</sup> Jan'y 1791, I have  
 admeasured and laid out unto  
 Samuel Wharton a tract of two hundred  
 and thirty six acres of land in said  
 district on a branch of Cain Creek  
 waters of Saluda river, bounded  
 N on Nicombecker & Thomas Ship  
 S on Burnside's like other boundaries  
 not known, and hath such form &  
 marks as the above Plat represents

SURVEY 16<sup>th</sup> Jan'y 1791,

John Rodgers Esq.

Recorded 12<sup>th</sup> Jan'y 1791 De. self  
 State of South Carolina Pursuant to warrant from  
 John Thomas Esq. Comr. of loc<sup>ns</sup> in Saluda, I have  
 admeasured and laid out unto Samuel Wharton a  
 tract of fifty eight acres of land in Laurens County  
 on a small branch of Nicombecker Creek, having  
 such shape, marks, bittings and bounding  
 as the above Plat represents

Recorded 12<sup>th</sup> Jan'y 1791,

Robt. Hanna Esq. De. self



State of South Carolina Pursuant to warrant  
 from John Thomas Esq. Comr. of loc<sup>ns</sup> in  
 26 District N Saluda Dated 17<sup>th</sup> Decr  
 1787, I have admeasured and laid

out unto James Wright a tract of one  
 hundred and eighty six acres  
 of land, on the ridge between  
 the S<sup>th</sup> & Middle fork of Tigger  
 river on the Charleston Road  
 leading from the Indian land  
 in Spartanburg County, bounding  
 by a line running N.E. by land unknown  
 S.E. by land thereon for Black and water  
 land, SW by legal survey for John Winder-  
 horst 1751 by James Wright's land, and hath  
 such shape form & marks, as the above Plat represents

Recorded 12<sup>th</sup> Jan'y 1791,

Wm. D. Thomas Esq.

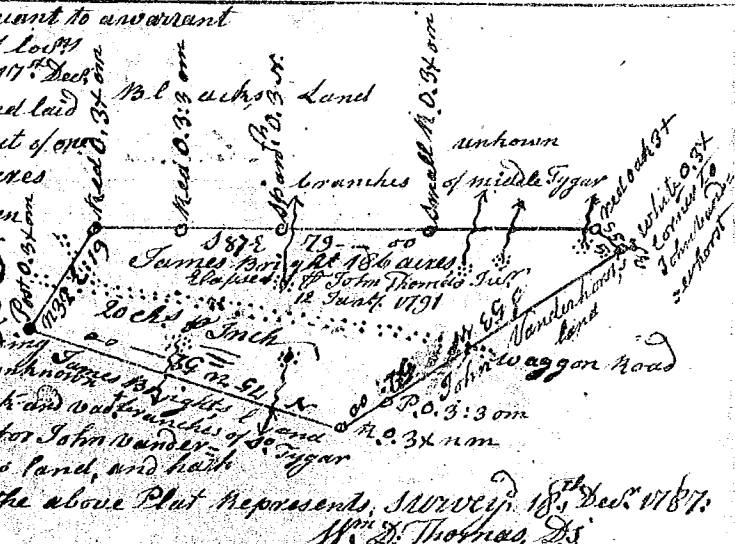

State of South Carolina Pursuant from John Thomas  
 Comr. of loc<sup>ns</sup> in Saluda I have admeasured &  
 laid out unto Christopher Brandon a tract of  
 100 acres of land, in Greenville County on  
 both sides of a small branch of the middle  
 fork of Saluda river, bounding by a line  
 running S 32 W. by land surveyed for John  
 Brandon all other sides on vacant land  
 and hath such shape form and marks as  
 the above Plat represents

Recorded 12<sup>th</sup> Jan'y 1791 -

SURVEY 16<sup>th</sup> Jan'y 1791

De. John Sest

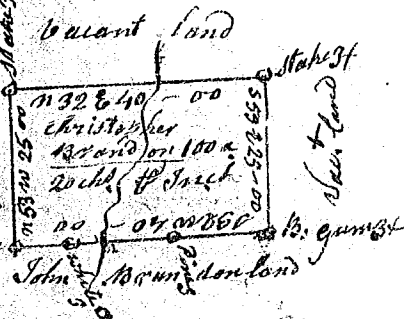

George Salmon Esq.