

State of S<sup>c</sup> Carolina Pursuant to  
 warrant from John Thomas  
 Com<sup>r</sup> of loc<sup>s</sup> N<sup>o</sup> Saluda river  
 I have admeasured and laid  
 unto William Holland a  
 tract of one hundred acres  
 of land on a small branch  
 of Duncans Creek in Laurens  
 County, having such shape, Marks  
 boundaries and boundings as the below

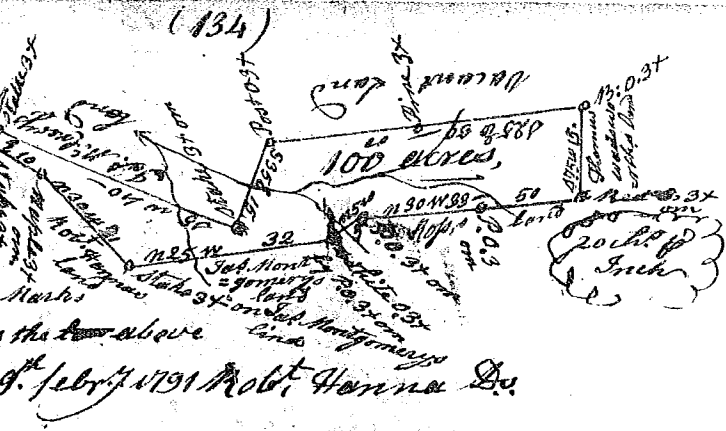

Plat Represents, Survey<sup>d</sup> 9<sup>th</sup> febr<sup>y</sup> 1791 Rob<sup>t</sup> Hanna D<sup>y</sup>  
 Recorded 19<sup>th</sup> april 1791

State of S<sup>c</sup> Carolina Pursuant  
 to a warrant from John Thomas Esq<sup>r</sup>  
 Com<sup>r</sup> of locations N<sup>o</sup> Saluda, I have  
 admeasured and laid out unto  
 Jonathan Johnson a tract of two  
 hundred and ninety five acres  
 of land on the branches of Middle  
 River in Laurens County having  
 such shape, form & Marks as the  
 above Plat Represents,  
 Survey<sup>d</sup> the 18<sup>th</sup> March 1791

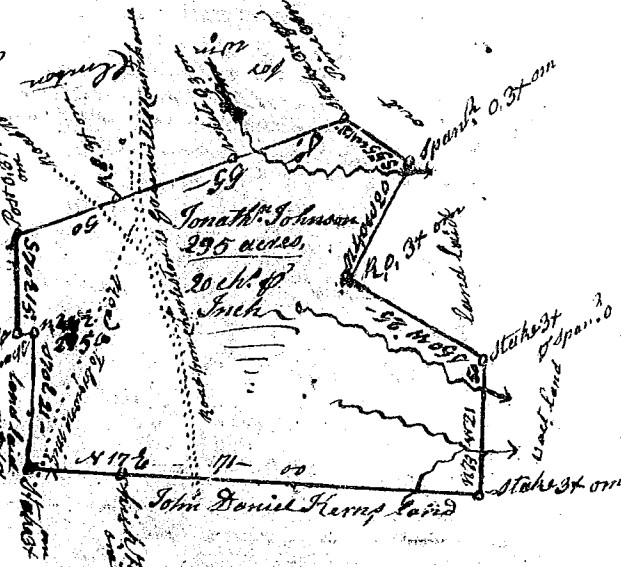

Rob<sup>t</sup> Hanna D<sup>y</sup>  
 Recorded 19<sup>th</sup> april 1791

State of S<sup>c</sup> Carolina Pursuant to a warrant from  
 John Thomas Esq<sup>r</sup> Com<sup>r</sup> of loc<sup>s</sup> N<sup>o</sup> Saluda river  
 I have admeasured and laid out unto William  
 Snow a tract of sixty four acres of land on a  
 small branch of Duncans Creek in Laurens  
 County, having such shape form and  
 Marks as the above Plat Represents, Survey<sup>d</sup>

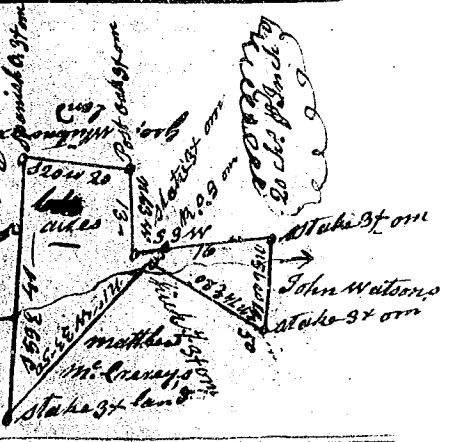

Survey<sup>d</sup> 13<sup>th</sup> March 1791  
 Recorded 19<sup>th</sup> april 1791, Rob<sup>t</sup> Hanna D<sup>y</sup>

State of S<sup>c</sup> Carolina Pursuant to a war-  
 rant from John Thomas Esq<sup>r</sup> Com<sup>r</sup> of  
 locations dated 23 March 1791 I have  
 admeasured and laid out unto  
 Thomas Bennett a tract of 743  
 acres of land in 96 district in  
 Spartanburg County on branches  
 of Thomsons Creek & Richland  
 Creek waters of Paolot river  
 bounded E on said Bennett,  
 S<sup>o</sup> on greenham Crowder &  
 abraham andrews N & N.W. on Daniel  
 White & John young set N<sup>o</sup> on Alex<sup>r</sup> Killpatrick and land laid out unknown  
 and hath such shape, form and Marks as the above Plat Represents,

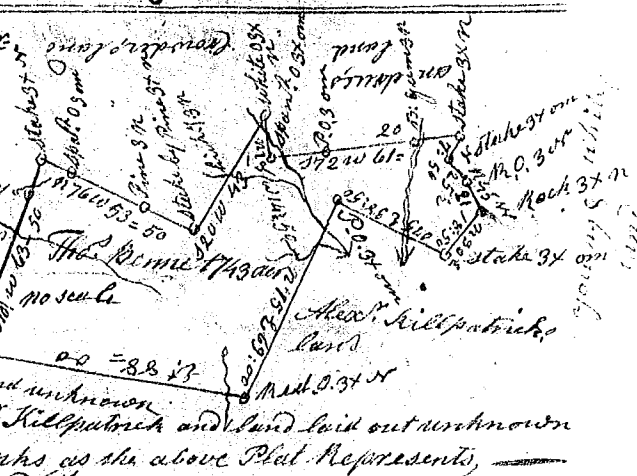

Survey<sup>d</sup> 8<sup>th</sup> april 1791 John Young Sur<sup>v</sup> D<sup>y</sup>  
 Recorded 5<sup>th</sup> May 1791 D<sup>y</sup> self,