

(164)  
 South Carolina Pursuant to a warrant from John  
 Thomas Esq. Comr of Recs, I have laid out unto  
 Daniel Springer a parcel, or tract of land of 200 acres  
 in Ninety Six District 3<sup>rd</sup> side of Broad river on the  
 branches of Buzzard Creek, and hath such shape form  
 Marks, buttings & boundings as the above Plat represents  
 Survey of 7<sup>th</sup> Dec<sup>r</sup> 1791. Charles Thomas Esq.  
 Recorded 6<sup>th</sup> Dec<sup>r</sup> 1791. Del. Self

South Carolina Pursuant to a warrant  
 from John Thomas Comr of Recs I have  
 laid out unto William Sims a tract of 1000  
 acres of land in 96 District on the side of  
 Broad river on the branches  
 of Hughes Creek, and hath  
 such shape form Marks  
 buttings and boundings as  
 the above Plat represents

Survey 29<sup>th</sup> Nov. 1791  
 Charles Sims Esq.  
 Recorded 8<sup>th</sup> Dec<sup>r</sup> 1791  
 Del. Ez. Springer

William Sims 1000 Acres -  
 Lockains Patch

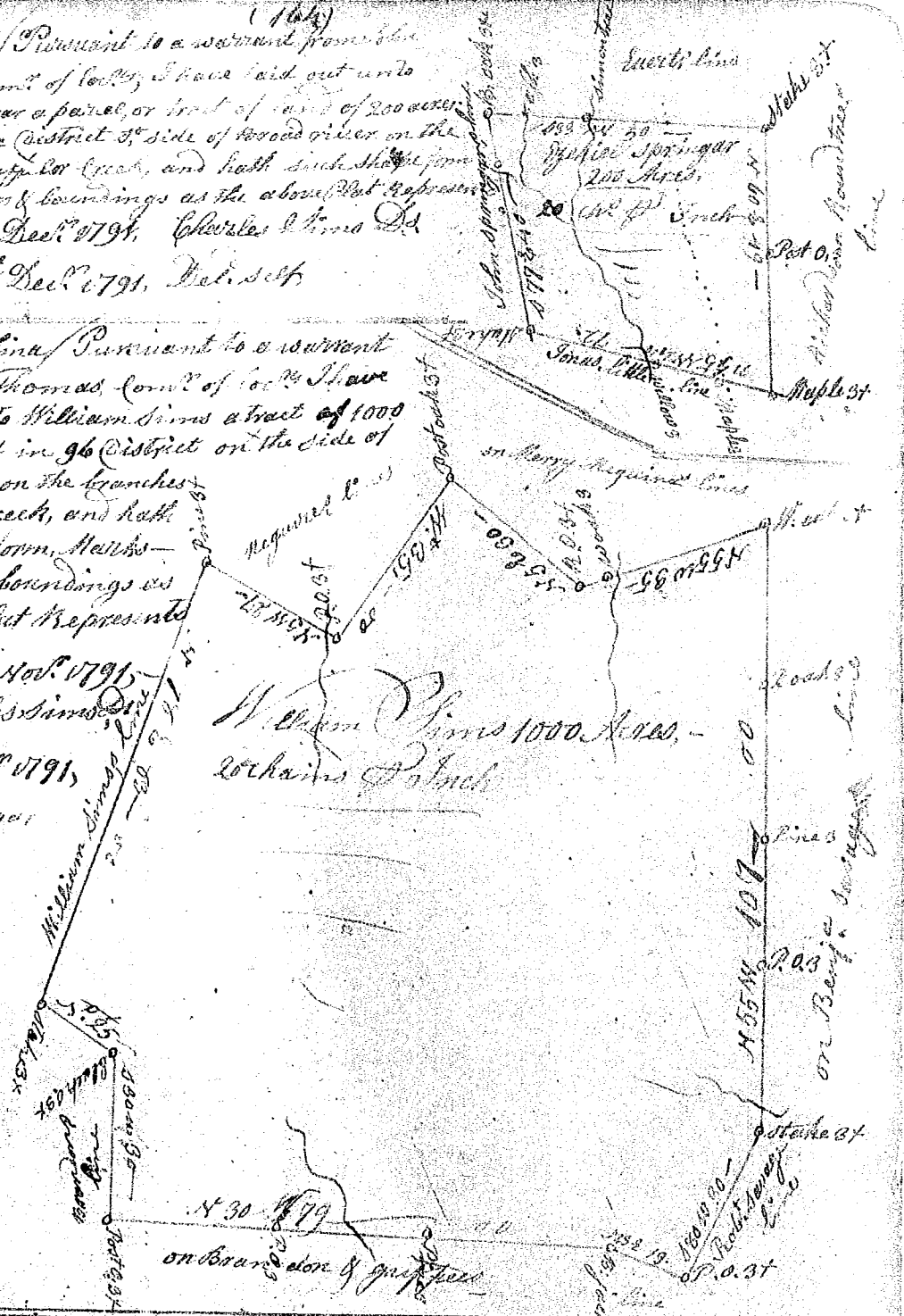

State of S<sup>c</sup> Carolina Pursuant to a warrant from John  
 Thomas Esq. Comr of Recs in 96 District S. of Saluda, dated  
 the 12<sup>th</sup> Dec<sup>r</sup> 1791 I have admeasured and laid out unto  
 James Gray a tract of Ninety four acres of land, in  
 said District on Wildcat Creek of 3<sup>rd</sup> Tiger river  
 in Greenville County bounded by a line running N.  
 by land survey for Joseph Doughty & act. land S.E. by  
 Shaws land S.E. by James Gray's son & S.E. by land  
 survey for Meredy Brogdon, SW. by land granted  
 to John Lucas, and hath such form Marks as  
 the above Plat represents,

Survey 12<sup>th</sup> Dec<sup>r</sup> 1791

Recorded 13<sup>th</sup> Dec<sup>r</sup> 1791

J. W. Thomas Esq.

