

South Carolina, Pursuant to a warrant from John Thomas Esq. Comr. of locations in 96 District of Saluda, dated the 29th July 1792, I have admeasured & laid out unto Benjamin Evans a tract of two hundred acres of land, for the County of Greeneville situate in 1st District on both sides of Gap Creek of the Middle fork of Saluda in Greenville County. Bounding by line NW by John Young Jun: SR by the said Benjamin Evans all other sides vacant land & hath such form & marks as the above plat represents. Witness the 22nd March 1792.

Recorded 23rd March 1792 Del. self
 J. Thomas Esq.

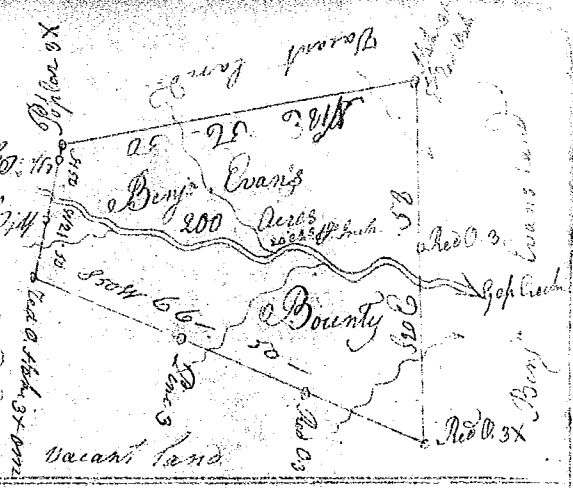

State of S^c Carolina, Pursuant to a warrant from John Thomas Esq. Comr. of locations to me directed, I have admeasured and laid out unto Joseph Hughes a tract of three hundred and forty acres of land, N^o side of broad river on Hughes' creek, Pinkney District, the above will more fully represent, Survey 19th March 1792.

Recorded 27th March 1792, Del. self
 Charles Sims Esq.

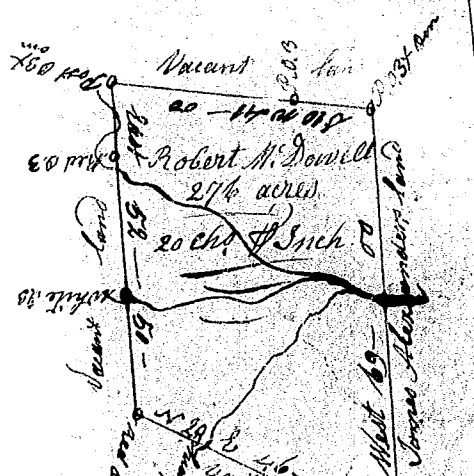
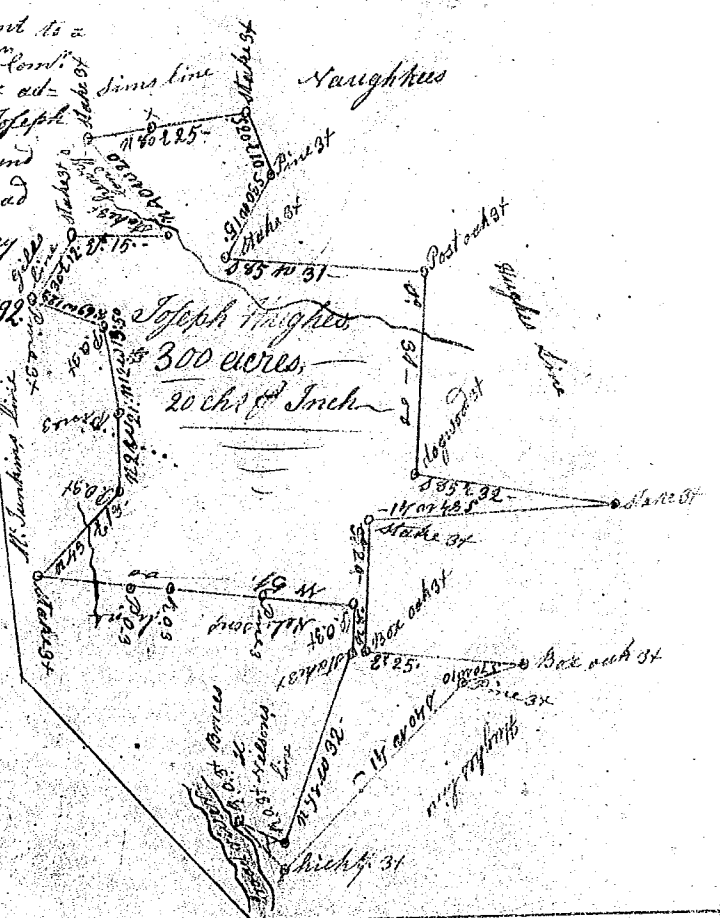

State of S^c Carolina, Pursuant to a warrant from John Thomas Esq. Comr. of locations N^o side Saluda river dated 10th March 1792, I have admeasured and laid out unto Robert M. Dowell a tract of two hundred and seventy six acres of land, in Spartanburg County on both sides of Bigels Creek of South Carolina river bounded S^o w^ordly by a line owning 1st by land belonging to James Alexander, all other sides by vacant land, and hath such shape and marks as the above Plat represents. Survey 20th March 1792. John Young Jun: Esq.

Recorded 20th March 1792,