

South Carolina Pursuant to a warrant (288)  
 from John Thomas Esq. Comr. of locs. Dated 23<sup>rd</sup> January 1794,  
 I have admeasured and laid out unto William Goldsmith  
 and Isaac Edwards a tract of two hundred and  
 seventy five acres of land in Pinckney District  
 on Sinker Creek, bounding by lines running  
 S. E. 42. S. E. by lands surveyed for Sedgehan  
 Porter, N. E. N. E. by lands surveyed  
 for Isaac Marchine N. W. by lands surveyed  
 for Henrich Porter, S. W. N. W. by land  
 survey for John Hill, S. W. by land  
 survey for John McCool, S. E. S. W.  
 by land survey for John Winters  
 all other sides on unknown lands  
 and hath such form & Marks as the  
 above Plat represents. Survey 10<sup>th</sup> March 1794,  
 Recorded 18<sup>th</sup> March 1794, Det. (C. W. Gordon) J. M. Gaston Esq.

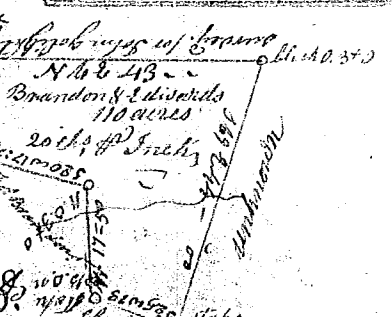

State of S<sup>c</sup> Carolina Pursuant to a warrant from John Thomas  
 Esq. Comr. of locations dated 12<sup>th</sup> febr'y 1794, I have admeasured  
 and laid out unto Thomas Brandon & Isaac Edwards a tract  
 of one hundred & ten acres of land in Pinckney District  
 waters of fairforest, bounding by lines running W. S. S. W. S. W.  
 by land survey for Thomas Brandon, N. E. by land survey for  
 John G. Lightly, S. W. by land survey for Charles Lewis and  
 other lands by unknown lands, and hath such form and  
 marks as the above Plat represents. Survey 13<sup>th</sup> febr'y 1794  
 Recorded 18<sup>th</sup> March 1794, Det. (C. W. Gordon) J. M. Gaston Esq.



S<sup>c</sup> Carolina Pursuant to a warrant from  
 John Thomas Esq. Comr. of locs. dated 20<sup>th</sup>  
 febr'y 1794, I have admeasured & laid out  
 unto James Turner a tract of one hundred  
 and sixty acres of land in Pinckney  
 District, Spartanburg County, on both  
 sides of a branch of Horse-Creek of Pacolet  
 river and on both sides of small of Pacolet  
 river, bounded N. E. & E. by Jesse Laxon's  
 and said Turners lands N. by William  
 Guereard's land S. & S. W. by lands laid out yet known S. by vacant land, and hath such shape  
 form & Marks as the above Plat represents. Survey 24<sup>th</sup> febr'y 1794, John Young Esq. Det.  
 Recorded 5<sup>th</sup> April 1794



S<sup>c</sup> Carolina Pursuant to a warrant from John Thomas Esq. Comr. of locs. dated 23<sup>rd</sup> Dec<sup>r</sup> 1793, I have admeasured  
 and laid out unto Dabney Brooks a tract of three hundred  
 and three acres of land in Spartanburg County on a branch  
 of Middle Eggar River bounding by lines running N. E.  
 by John McElhones land N. W. by land survey for Peter  
 Clarke S. W. & S. E. by Dabney Brooks land W. vacant  
 S. E. by the ancient boundary line survey for Nobbs &  
 Watson S. unknown, and hath such form and marks  
 as the above plat represents. Survey 21<sup>st</sup> Dec<sup>r</sup> 1793  
 Recorded 5<sup>th</sup> April 1794, J. M. Thomas Esq.

