

S^c Carolina Pursuant to a warrant (339) from John Thomas Com^r of loc^s I have admeasured and laid out unto William and John Young a tract of one thousand acres of land in Washington District Greenville County on both sides of Fall Creek of Middle fork of Saluda river bounded N.E. & W. by said youngs lands S.E. by John^r Elliss land S.W. by vacant land and hath such shape form & marks as the above Plat represents Survey 18th May 1793. J. John Young J^r D^s Recorded 24th Sept^r 1794. Det. self

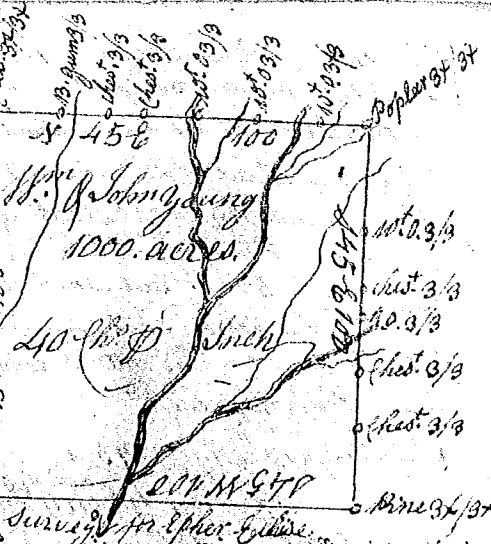

S^c Carolina Pursuant to a warrant from John Thomas Com^r of loc^s I have admeasured and laid out unto William and John Young a tract of 1000 acres of land in Washington District Greenville County on both sides of ~~the~~ Littleton's ~~branch~~ branch of Middle fork of Saluda river bounded S.E. by Littleton's & vacant land all other sides by said youngs land, and hath such shape form & marks as the above Plat represents Survey 17th May 1793. J. John Young J^r D^s Recorded 24th September 1794 Det. self

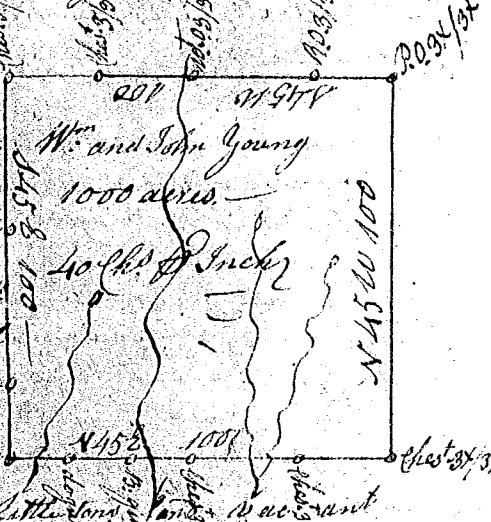

S^c Carolina Pursuant to a warrant from John Thomas Com^r of loc^s I have admeasured and laid out unto William and John Young a tract of 1000 acres of land in Washington District Greenville County on the branch of Still-havese Creek of Middle fork of Saluda river. Bounded S.W. by vacant land, all other sides by said youngs lands, & hath such shape and marks as the above plat represents.

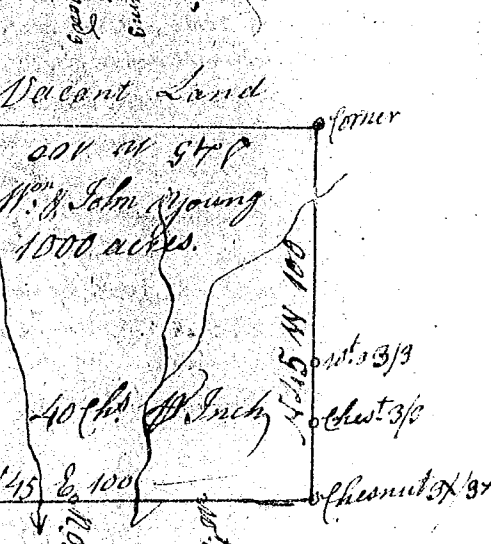

Survey 17th May 1793.
 Recorded 24th Sept^r 1794.
 Det. self
 John Young J^r D^s