

South Carolina Pursuant to a warrant from John Thomas Com<sup>r</sup> of Col<sup>y</sup> I have admeasured and laid out unto W<sup>m</sup> & John Young a tract of 1000 acres of land in Washington District Greenville County on both sides of Cyle Camp Creek waters of the middle fork of Saluda River, and on the head branches of Waticoo Creek of the st<sup>h</sup> fork of Saluda bounded S. & W. by said Youngs lands, N.W. by John Woods Land S.W. vacant, and hath such shape form & marks as the above Plat represents Survey 16<sup>th</sup> May 1793 Recorded 24<sup>th</sup> Sept<sup>r</sup> 1794 del<sup>d</sup> self

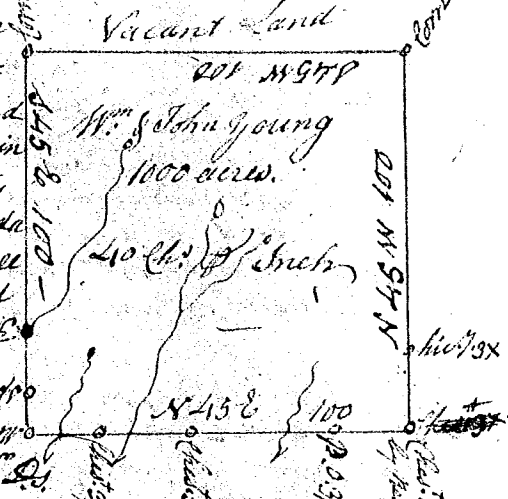

S<sup>c</sup> Carolina Pursuant to a warrant from John Thomas Com<sup>r</sup> of Col<sup>y</sup> I have admeasured and laid out unto William and John Young a tract of 1000 acres of land in Washington District Greenville County on the branches of the middle fork of Saluda river bounded N.W. by vacant land all other sides by said Youngs lands, and hath such shape and marks as the above Plat represents. Survey 17<sup>th</sup> May 1793 Recorded 24<sup>th</sup> Sept<sup>r</sup> 1794 John Young j<sup>r</sup> D<sup>s</sup>



S<sup>c</sup> Carolina Pursuant to a warrant from John Thomas Com<sup>r</sup> of Col<sup>y</sup> I have admeasured and laid out unto William and John Young a tract of 1000 acres of land in Washington District Greenville County on both sides of the middle fork of Saluda river, bounded S. by John Woods Land, S.E. & W.E. by said Youngs land, S.W. & N.W. by vacant land, and hath such shape form & marks as the above Plat represents. Survey 15<sup>th</sup> May 1793 Recorded 25<sup>th</sup> Sept<sup>r</sup> 1794 del<sup>d</sup> self

