

343  
 Carolina Pursuant to a warrant  
 = warrant from John Thomas Esq. & Co. Surveyors  
 I have laid out unto Charles D. Bradford  
 = ford a tract of 1000 acres of land  
 in Washington District Greenville  
 County on the waters of the S<sup>e</sup>  
 Fork of Pacolet river having  
 such shape, form, marks  
 & boundaries as the above plat represents.  
 Survey 21<sup>st</sup> March 1794.  
 R. F. Winn Esq. Surveyor

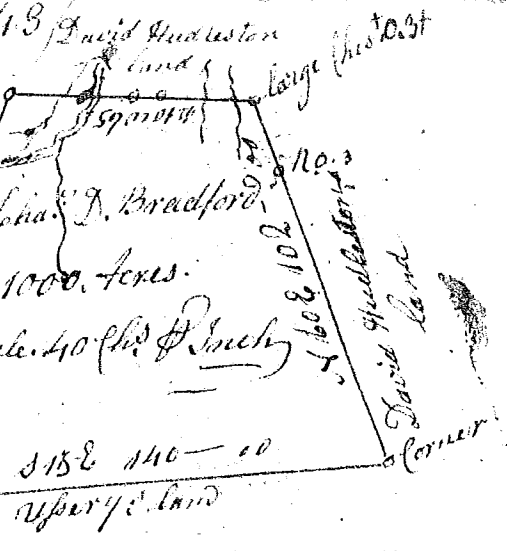

Recorded 29<sup>th</sup> Sept. 1794  
 R. F. Winn Esq. Surveyor

Carolina, Pursuant to a  
 warrant from John  
 Thomas Esq. & Co. Surveyors  
 I have laid out to Charles D. Bradford  
 a tract of land containing  
 One thousand acres  
 situated in Washington Charles D. Bradford  
 District and Greenville County on waters of South Pacolet and  
 head of Saluda rivers having such shape & marks boundaries &  
 boundaries as the above plat represents. Certified for 21<sup>st</sup> March  
 1794. R. F. Winn Esq. Surveyor. Recorded 29<sup>th</sup> Sept. 1794

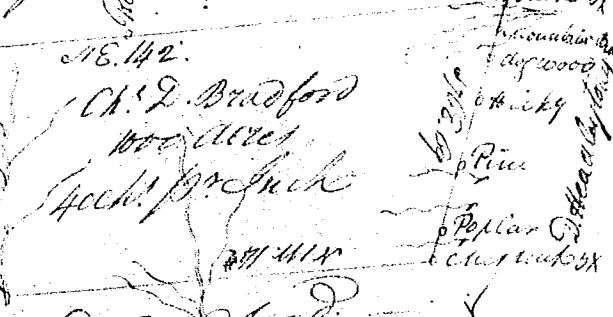

Carolina, Pursuant to a  
 warrant from John  
 Thomas Esq. & Co. Surveyors  
 I have laid out to Charles  
 D. Bradford a tract of land  
 containing One thousand  
 acres situated in Washington  
 District & County of Greenville  
 on the head waters of Pacolet &  
 Saluda Rivers having such  
 shape form & marks boundaries  
 & boundaries as the above plat  
 represents. Certified for  
 this 21<sup>st</sup> day March 1794  
 R. F. Winn Esq. Surveyor  
 Recorded 29<sup>th</sup> Sept. 1794

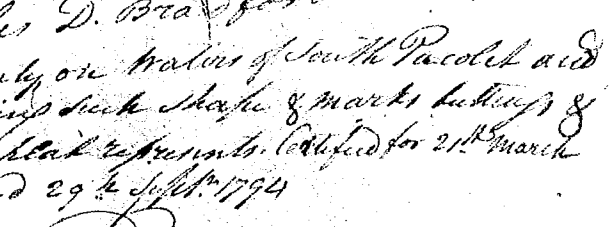

Recorded 29<sup>th</sup> Sept. 1794  
 R. F. Winn Esq. Surveyor

