

State of Carolina, Chatham Co. 4411

Pursuant to a warrant  
issued in Thomas vs. Robt.  
Waltice the 6th day of 1797. I have  
examined the plat returned  
Robt. Waltice, a tract of  
5000 square feet of land  
situated in the county of Chatham  
State of Carolina bounded  
north by the land of James  
Waltice, east by the land  
of Thomas Patmore, south  
by Thomas Patmore, and  
west by the land of Robt.  
Waltice, and by both length  
and breadth as the above plat  
represents  
Witness my hand and seal  
this 25th day of July 1797.  
Recorded the 7th day of July 1797  
James L. Lawrence  
Notary Public

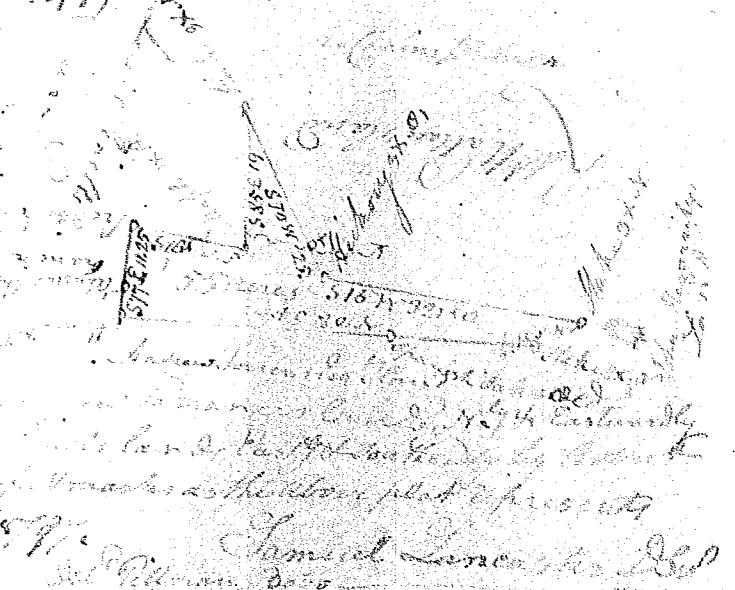

South Carolina Pursuant to a warrant  
issued in Thomas vs. Robt.  
Waltice dated 6th day of July 1797  
I have examined the plat  
returned Robt. Waltice  
a tract of 5000 square feet  
of land situated in the  
county of Chatham  
State of Carolina bounded  
north by the land of James  
Waltice, east by the land  
of Thomas Patmore, south  
by Thomas Patmore, and  
west by the land of Robt.  
Waltice, and by both length  
and breadth as the above  
plat represents  
Witness my hand and seal  
this 25th day of July 1797.  
Recorded the 7th day of July 1797  
James L. Lawrence  
Notary Public

