

South Carolina / Pursuant to Warrant

from John Thomas, Com<sup>r</sup> of both S<sup>d</sup> Side Saluda dated 17<sup>th</sup> Aug<sup>r</sup> 1793. I have admeasured and laid out unto Thomas Macey a tract of one hundred acres of land in Washington District in the mountains with vacant land on both sides of Green Creek of South Carolina in the mountains of Greenville County. Bounding by lines running N. 81. E. 1/2 by lands granted to Lemuel M. (Cure) all other sides by vacant mountains and hath such form and marks as the above plat represents Surveyed the 17<sup>th</sup> of January 1793 Wm D. Thomas Esq<sup>r</sup> Elected by Larkin Ryland 24 Dec<sup>r</sup> 98

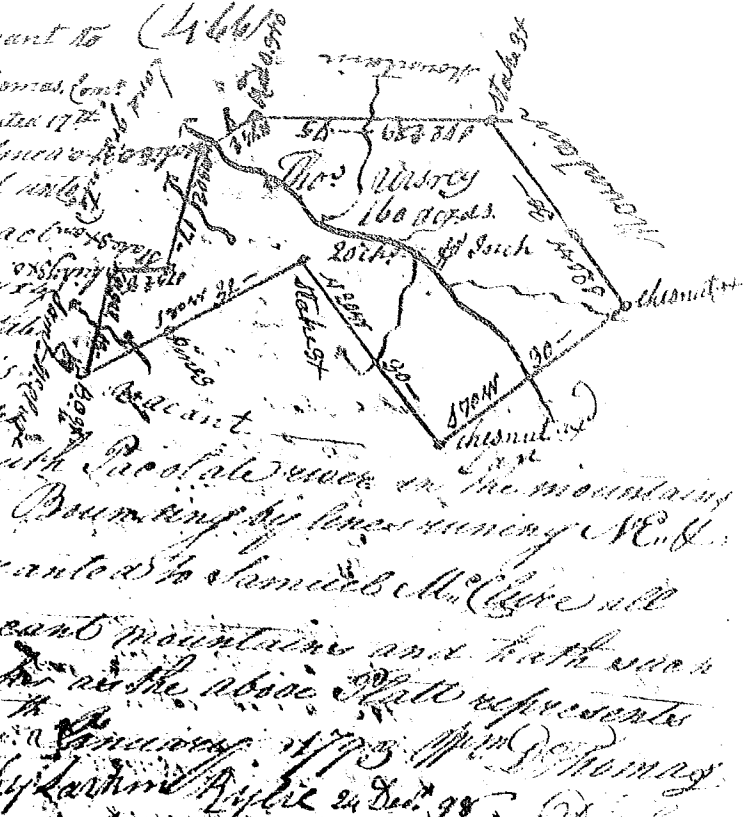

State of S<sup>c</sup> Carolina Pursuant to warrant from John Thomas, Com<sup>r</sup> of South dated 27<sup>th</sup> March 1794, I have admeasured and laid out unto Abraham Elledge a tract of two hundred and ten acres of land in Washington District in South Carolina and on both sides of Wolf Creek of said river in Greenville County bounded by lines running N. 34. E. 3/4 by Henry Copers land S. E. and by William Savage's land, S.W. by Benjamin and Mark as the above plat represents.



Recorded the 24<sup>th</sup> Dec<sup>r</sup> 1798

Surveyed 4<sup>th</sup> April 1794

Elected by Larkin Ryland Wm D. Thomas Esq<sup>r</sup> 24 Dec<sup>r</sup> 98

State of S<sup>c</sup> Carolina Pursuant to warrant from John Thomas Com<sup>r</sup> of S<sup>d</sup> Side Saluda dated 16<sup>th</sup> Nov<sup>r</sup> 1798, I have admeasured and laid out unto George Robt a tract of seventeen acres of land, on the North side of the road between Inozee & brush creek of said river bounded by lines running S. E. by Moses Drapier's land N. 34. E. 3/4 by said George Robt's land and hath such shape & marks as the above plat represents.

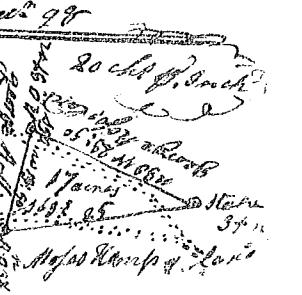

Recorded 27<sup>th</sup> Dec<sup>r</sup> 1798

Surveyed 17<sup>th</sup> Nov<sup>r</sup> 1798 Wm D. Thomas Esq<sup>r</sup>