

Date of warrant
of 11th Oct. 1791

Laid down by a scale
of 10 Chains to an Inch

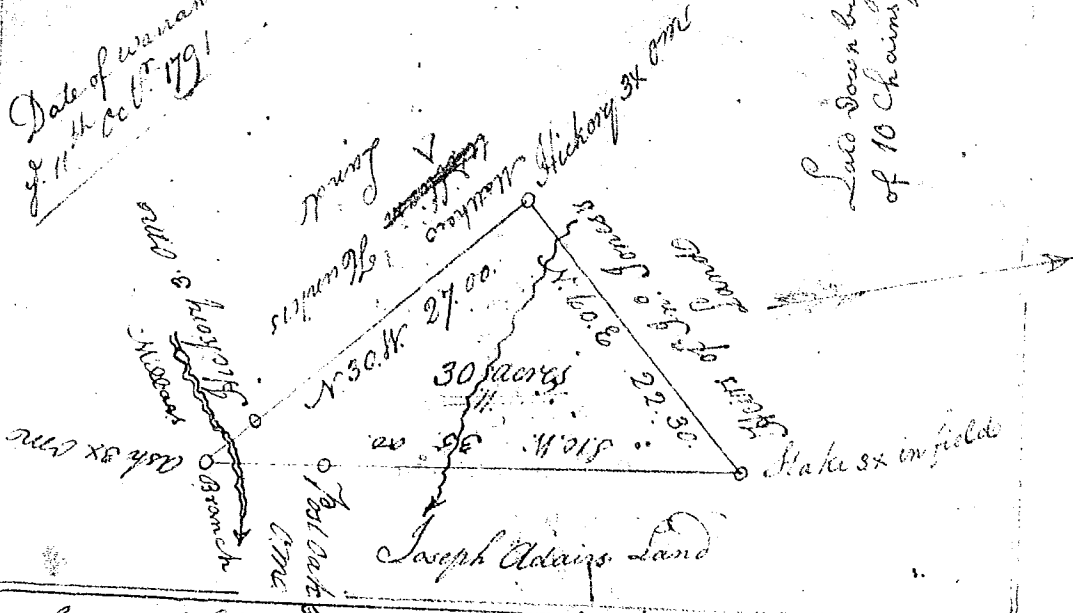

State of S. Carolina

Pursuant to a warrant from John Thomas Esq
Commissioner of Locations N. Saluda River I have ad-
-measured and laid out unto John C. Adair a Tract of
Thirty Acres of Land on a Fork of Duncans creek called
Millers Branch in Laurens County having such Shape
Marks Buttings and Boundings as the above plat Represents
Surveyed the 11th Oct. 1791

Robert Scanna

Dep. Surv.

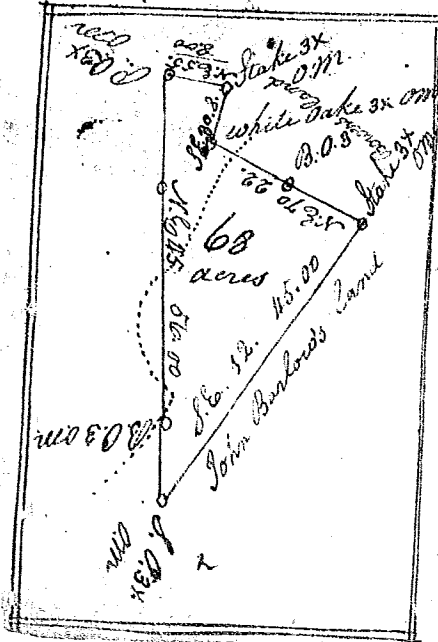

State of S. Carolina

Pursuant to a warrant from
John Thomas Esq. Com. of Locations dated
the 1st day of June 1791. I have admeasured
and laid out unto John Johnson a Tract of
Sixty Eight Acres of Land, Situate in
Six District on waters of Wms Creeke waters
of Broad River & hath such Shape Marks
Buttings and Boundings as the above plat
Represents -

Surveyed the 17th day of Oct. 1791
Jos. Wright D.S.