

Date of war. ye. of Nov. 1791

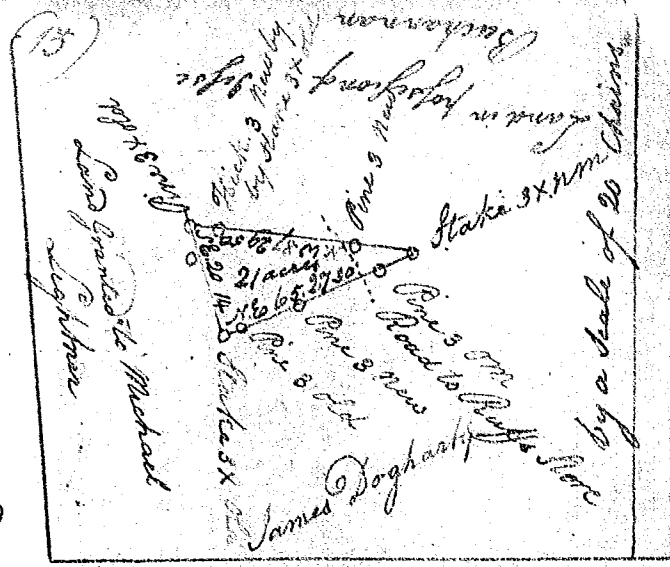

South Carolina

Pursuant to a warrant from John Thomas Esqr Comr. of Locations in Ninety six district I have admeasured & laid out unto Martin Croomer a tract of Twenty one acres of Land Situate in Newberry County lying between Second Creek & Rattle snake Branch the waters of Broad River & hath such Boundaries form Shape Marks &c as the above plat Represents.

Surveyed this 12th day of Nov. 1791

G. Harbert D.S.

State of S. Carolina

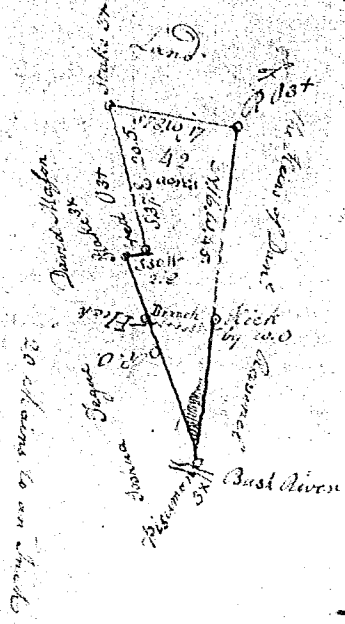

Pursuant to a warrant from John Thomas Esqr Comr. of Locations for the district of Ninety six; I have measured & laid out unto John Sason a Tract of Land containing forty two acres lying on the waters of Bush River in S. District; & hath such form Shape Markings & Boundings as the above plat Represents

Surveyed the 21st day of Nov. 1791

John Diamond D.S.