

South Carolina
 Greenville Co. Pursuant to a warrant from John Thomas Esq.
 Comr. of Locations N. Saluda River dated the 21st
 Jan^y 1792. I have admeasured and laid out unto Hugh Cromwell
 a Tract of land containing Six hundred & fifty four acres, on the branches
 of Mountain Creek & Bounding N. on Isaac James, Eastwardly on
 Drury Hogges & Thomas Bristow S. on Christopher Brunk's Charles Estie
 W. on Christopher Brunk's & hath such shape form & Marks as the
 above plat doth Represent. — Surveyed the 25th January 1792
 John Rodgers D.S.

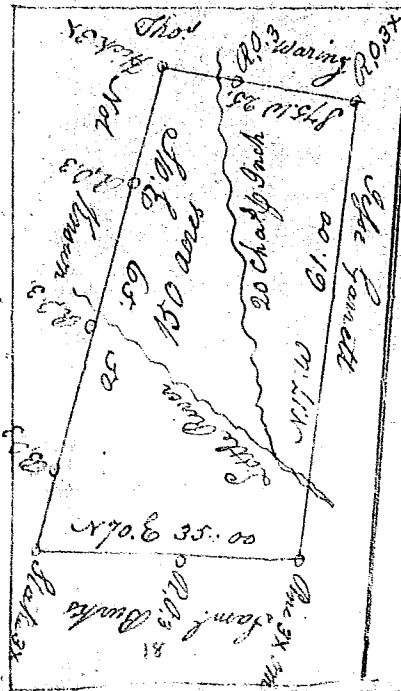

S. Carolina & Pursuant to a warrant
 Laurens County from John Thomas Esq.
 Comr. of Locations N. Saluda River dated the
 19th day of Dec. 1791. I have admeasured and
 laid out unto Jesse Garrett one hundred & fifty
 acres of land situated in said District on the
 Branches of Little River Bounding N. on Thomas
 Waring - E. on said Garrett S. on Saml. Brunk's
 west Not known & hath such shape form &
 marks as the above plat Represents. —
 Surveyed the 20th Dec. 1791
 John Rodgers
 D.S.