

State of South Carolina

Pursuant to a warrant from John Thomas Com^r of Locations in Ninety Six District N^o. Saluda, Dated the 11th day of Oct^r. 1791. I have Measured and laid out unto Jesse Barker a tract of two hundred & sixty six acres in the said District Situate lying on the Branches of the Beaver dam Creek the waters of Enoree River Running S.W. with Martin Williams Land & N.W. with Lightears Land and N^o. with Wolfs, & East with Vanderhorst's and N^o. and S.E. & N.E. with Thomas Alison's and S.W. with Benjamin Griffiths Land and hath such and Marks as the above plat Represents.

Surveyed the 14th Oct^r. 1791.

James Wofford D.S.

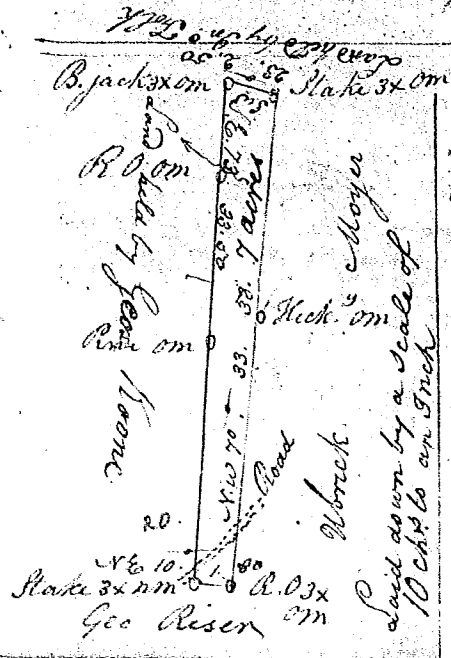

South Carolina

Pursuant to a warrant from John Thomas Esq^r Com^r of Locations in 96th District dated the 15th February 1792. I have admeasured and laid out unto John Benedict Moyer a tract of seven acres of Land Situate in S^o. District & Newbury County on the drains of Grims Creek the waters of Broad River and hath such form shape &c. as the above plat Represents

Surveyed the 17th February 1792

Geo Harbert D.S.