

S^o Carolina

Pursuant to a warrant from John Thomas Esq. Com. of Locations in Saluda dated the 6th day of Oct. 1793 I have measured and laid out unto William Caldwell a tract of One hundred & fifty acres of Land on Mudlick Creek in Newbury County bounded N. on Thomas Turners Land, S. on George Elliotts Land S.W. on John Barlowes Land and S.E. on Benjamin Collins Land

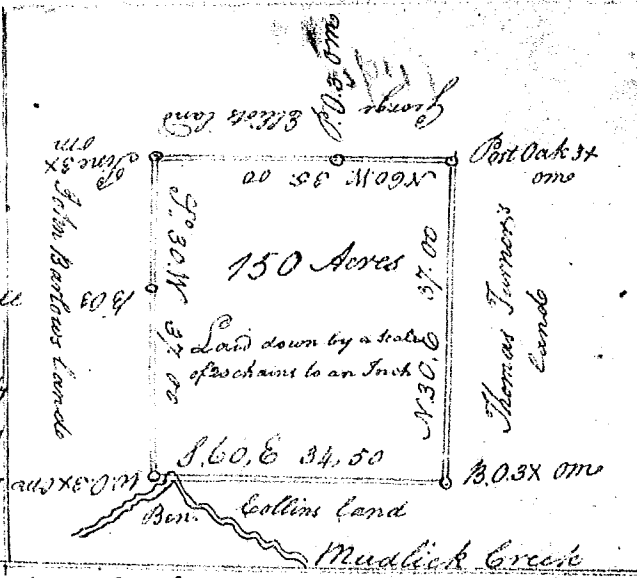

and hath such form and marks as the above plat represents

Surveyed the 9th day of ~~October~~ ^{October} 1794

William Caldwell
D.S.

S^o Carolina

Pursuant to a warrant from John Thomas Esq. Com. of Locations in Saluda, dated the 16th Dec. 1793. I have measured and laid out unto John Blackburn a Tract of forty seven acres of Land on Newbury County on the Waters of Indian Creek bounding on a line N. on James Bonds Land by lines running S. and S.E. by w^o Blackburns Land and on all other sides by Land Surveyed for John James

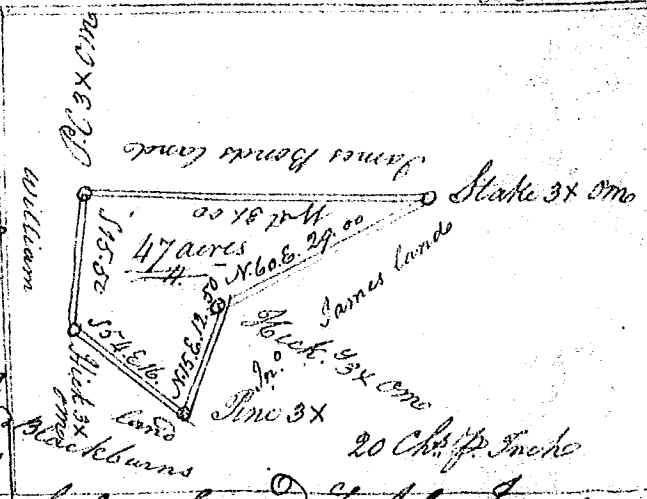

and hath such form and marks as the above plat represents

Surveyed the 28th December 1794

Abel Pearson Del.