

1874

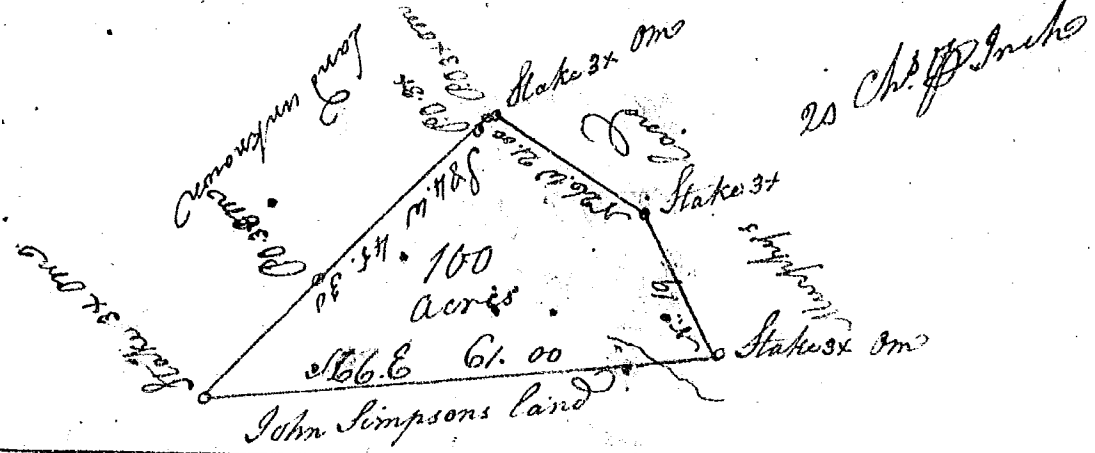

S^c Carolina Pursuant to a warrant from John Thomas Esq. Com^r of Locations N^o Saluda dated the 1st Nov^r 1793 I have admeasured and laid out unto John Simpson a tract of one hundred acres of Land in Laurens County Bounding by a line Running S 66. E. 61 Chains on land of John Simpson's thence N. 19 Chains on Thomas Murphy's land thence N 26 W 21 Ch. 18 1/2 W 45 Ch. 30 links on land unknown lying on the waters of Duncan's Creek & hath such form and marks as the above plat Represents— Surveyed the 6th day of Nov^r 1793
 John Hunter Esq

20 Chains of Inlets

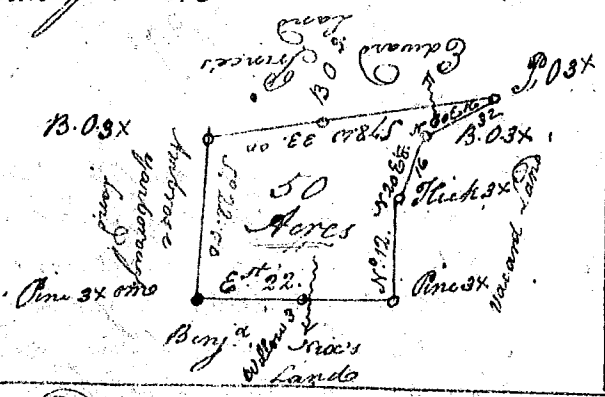

S^c Carolina Pursuant to a Warrant from John Thomas Esq. Com^r of Locations N^o Saluda dated the Eighth day of August 1793 I have admeasured and laid out unto Waterman Boatman a tract of fifty acres of land in Union County on the N. Side of Tyger River Bounded to the S^o by Benjamin Willard's land Easterly by vacant land & by Edward Pringers land and hath such form and marks as the above plat Represents: Surveyed 10th Sept^r 1794
 Andrew Thomson Esq

S^c Carolina Pursuant to a warrant from John Thomas Esq. Com^r of Locations N^o Saluda dated the 19th day I have admeasured and laid out unto John Bowland a tract of ninety two acres of land in Laurens County Bounded S. on land laid out to Nathan Brown, E. on William Scott's land N. on John Lindsay's land, W. on Braselmann's land and N.E. on land John Bowland's land and hath such form and marks as the above plat Represents— Surveyed the 19th Feb^r 1794
 Robert Hoanna Esq

