

Unl'd Nat Henderson 152 acres
Spartanburg County on a branch
of Harriess Creek Beginning on
Ginnards Land & so Round as
per plat Survey 2d March 1795

(257)

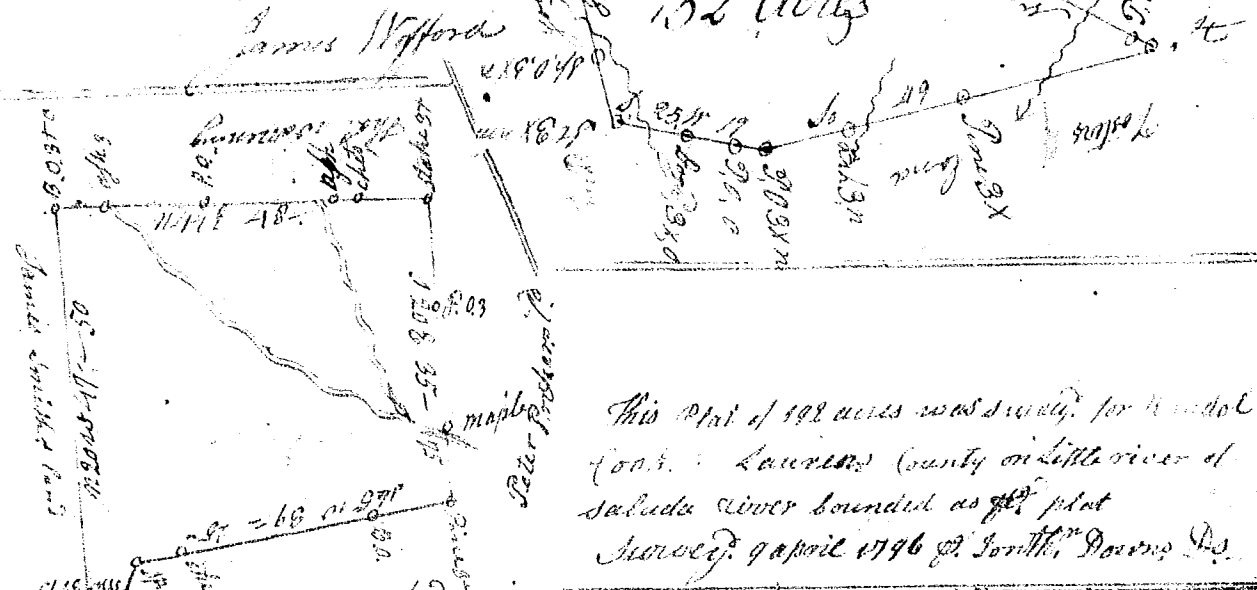

This plot of 198 acres was survey'd for Daniel
Cook in Laurens County on Little river of
Saluda river bounded as per plat
Survey'd 9 April 1796 by Jonathan Downes D.S.

This amended plot of 200 acres
was survey'd for John Harry in
Laurens County, dated 25 May 1794,
on Harriess Creek, South, Sec 6
May 1794 by John Rodgers D.S.

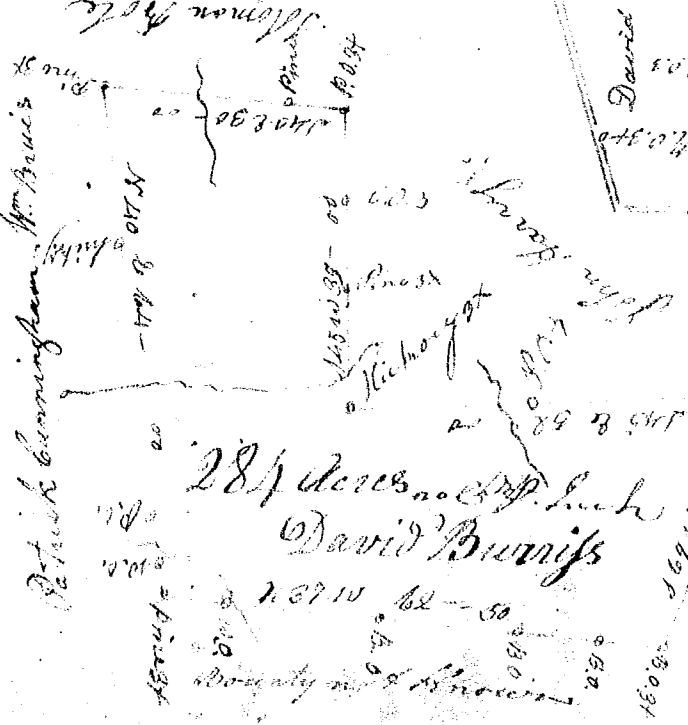
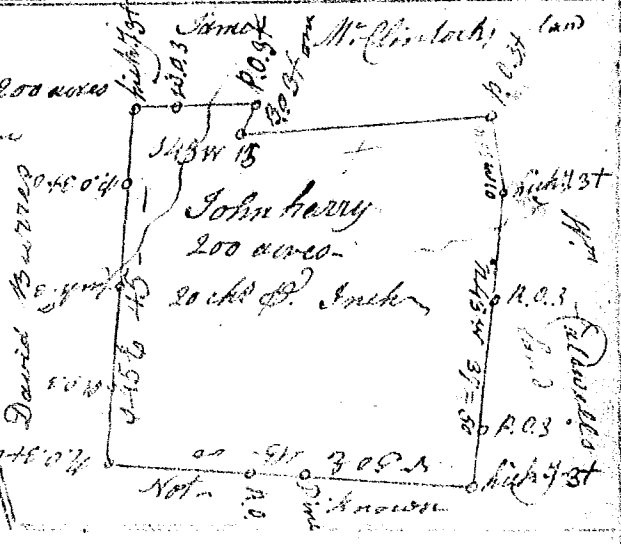

This plot of 284
acres on the waters
of Harriess fork of Harriess
Creek, in Laurens
County bounded as per
plat was survey'd
the 16th April 1795
for David Burns
by John Rodgers D.S.