

A tract of 500 acres will be made in Lenoir County by the Outlet of Broad River in Union County between Broad Creek the walls of Broad River and bounded as the Plat they 5th July 1797
 John Foster

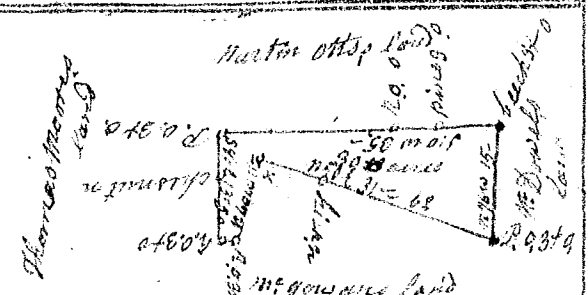

This plot of 30 acres in Sp. Stanbury County on west side of Tiger River bounding as the Plat, was surveyed for Samuel Otis the 19 July 1797. — by David Wofford Esq.
 Recorded 25 July 1797

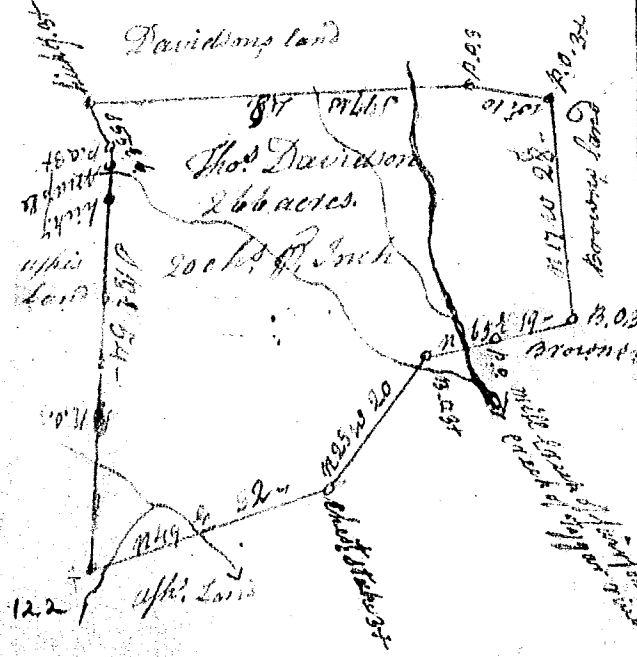

This Plot of 266 acres in Sp. Stanbury County on branches of Storge mill creek of fairness creek of Tiger River, bounded as the Plat, was surveyed for Thomas Davidson the 20th Feb 1798. — by David Smith Esq.

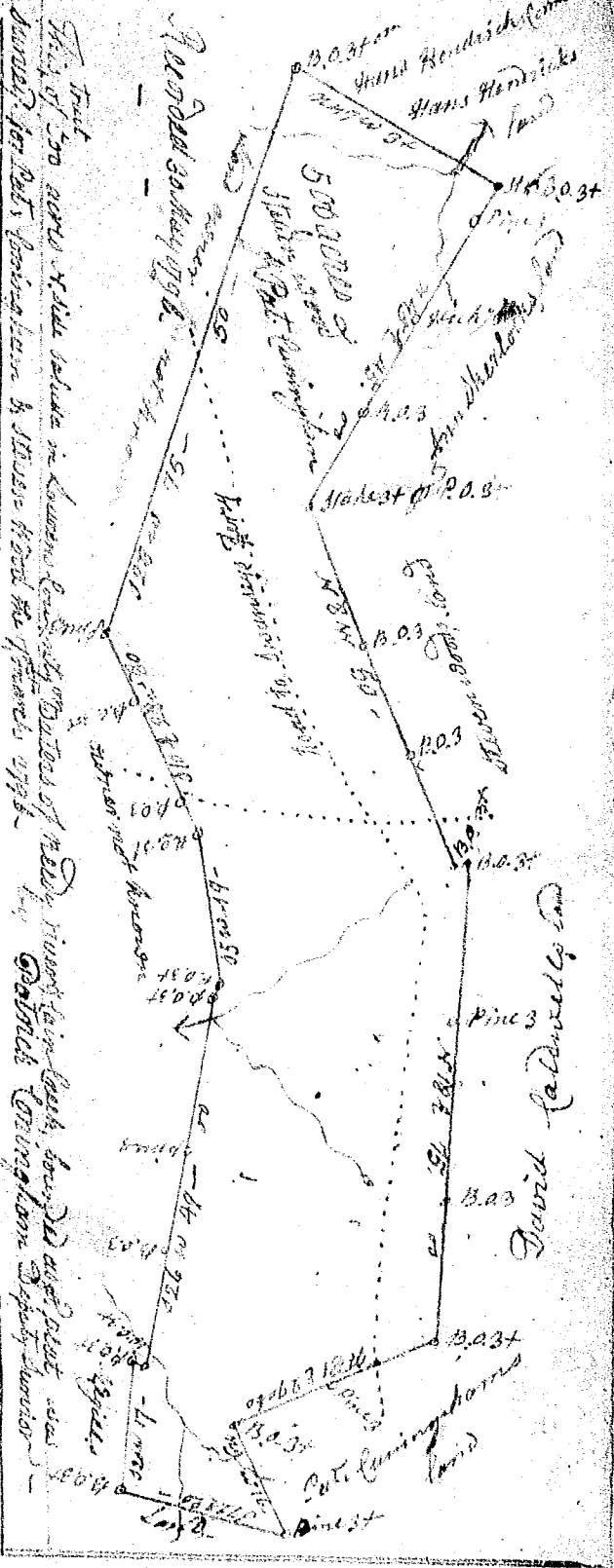

This Plot of 500 acres will be made in Lenoir County by the Outlet of Broad River in Union County between Broad Creek the walls of Broad River and bounded as the Plat they 5th July 1797
 John Foster