

State Carolina  
 Pursuant to a warrant from  
 John Thomas Esq.  
 C. L. n. of Saluda River  
 dated the 29<sup>th</sup> Oct 1799  
 I have admeasured  
 & laid out unto Francis  
 Rofs a tract of land  
 containing two hundred  
 & eighty six & 50/100  
 Acres, situate in  
 Greenville County  
 lying on Mountain creek  
 waters of Saluda River  
 bounding on all sides  
 on vacant land or  
 Land unknown. I have  
 here out Unknown  
 plat represents Survey  
 the 1<sup>st</sup> Nov 1799  
 Recorded the 11<sup>th</sup> Nov 1799  
 Benj<sup>r</sup> Arnold

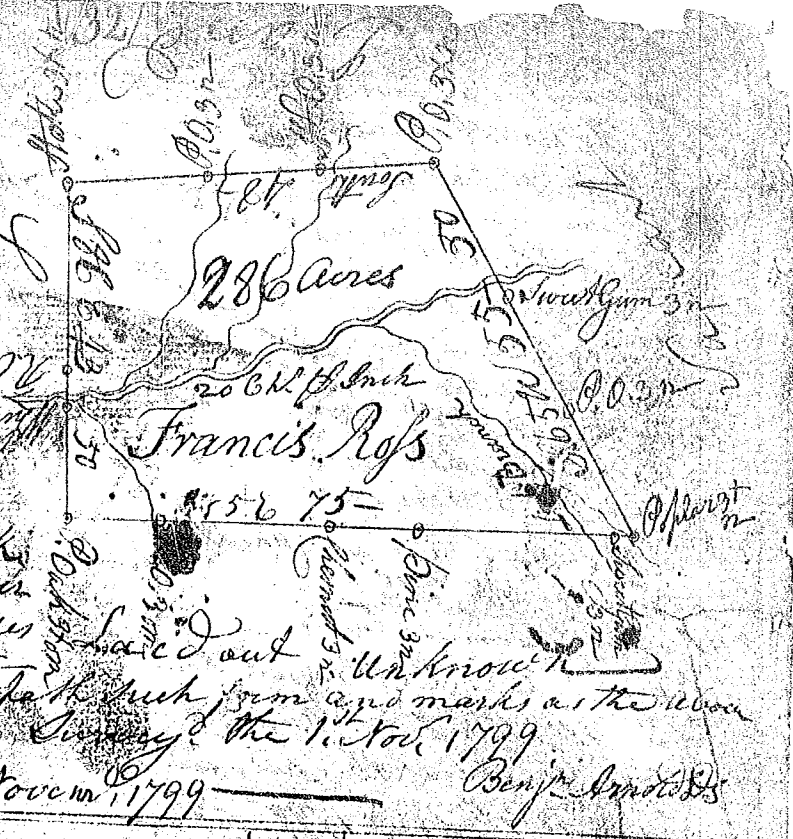

State Carolina  
 Pursuant to a warrant  
 from John Thomas Esq.  
 C. L. n. of Saluda River  
 dated the 29<sup>th</sup> Oct 1799  
 I have admeasured & laid  
 out unto Francis Rofs  
 a tract of land containing  
 three hundred & thirty six  
 acres, situate in Greenville  
 County lying on Mountain  
 Creek waters of Saluda River  
 bounding on all sides by vac-  
 ant Land or Land Unknown and  
 hath been from marks as  
 the above plat represents  
 Survey'd the 1<sup>st</sup> day of Novem<sup>r</sup> 1799  
 Benj<sup>r</sup> Arnold

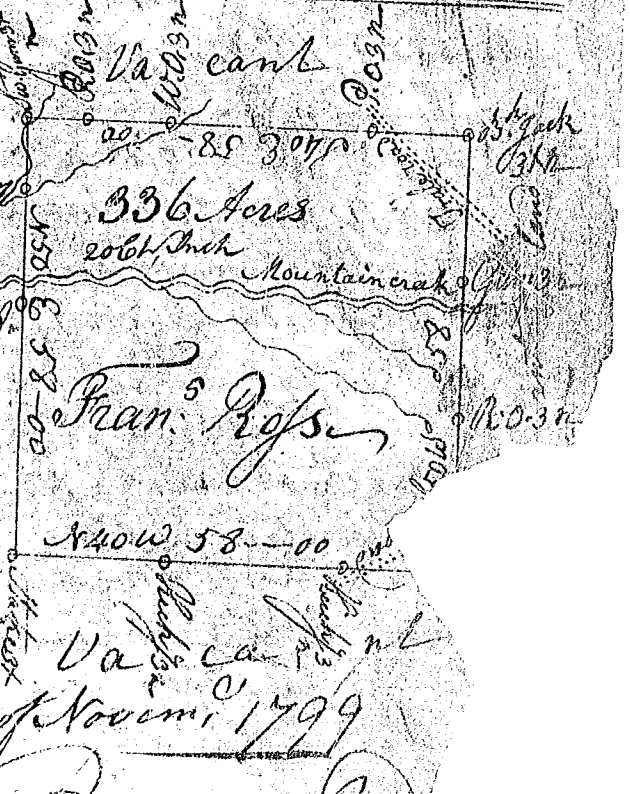

Benj<sup>r</sup> Arnold  
 Recorded the 11<sup>th</sup> Nov 1799