

(188)
 State of Carolina Pursuant to a warrant from
 John Thomas, Comr. of loc. S. side
 of Vol. 10 dated 24 Febry 1801. I have surveyed
 for George Estlinger tract of two hundred
 and thirty acres of land in
 Spartanburgh District, on Morgan branch
 of S Ouleet river emptying in on N side
 bounded N by Andersons & M. Livers land
 E. by William Andersons land S by Mor-
 gan land W by Gilberts land, and
 with such shape & marks as the above
 Plat Represents, Survey 25th Sept^r 1801
 Recorded 28th Sept^r 1801 } by Jas Smith Ds

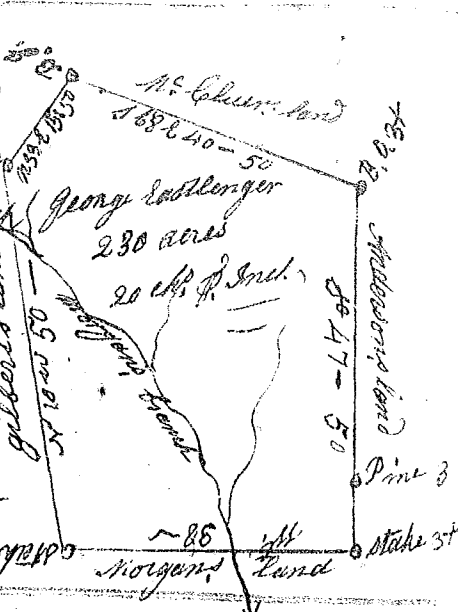

State of S^c Carolina Pursuant to a warrant from
 John Thomas, Comr. of loc. S. side
 of Vol. 10 dated 24 Febry 1801. I have admeasured and
 laid out unto Henry &
 Sophia Benson tract of
 ninety eight acres of land
 in Spartanburgh District
 on lines running N. and
 S. by Sophia Edwards land W. by
 Samuel Hendricks. S. by William Hendricks
 E. & S. Major Toomers land, the other side by
 the meanders of a small
 branch of the Meedy fork water of Tyger river, and hath such shape
 and marks as the above plat Represents, Survey 25th febr^y 1801,
 Recorded 11th Oct^r 1801, —

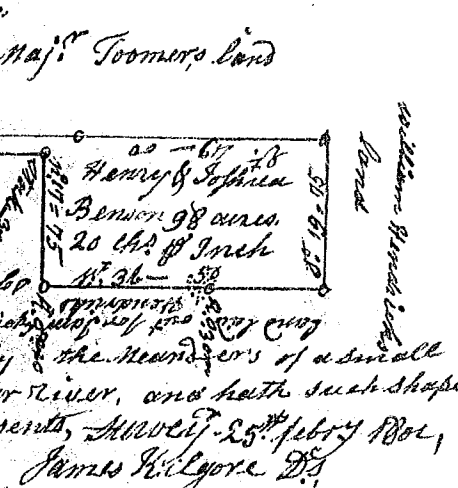

State of South Carolina Pursuant to a warrant
 from John Thomas, Comr. of loc. S. side
 of Vol. 10 dated 1st Sept^r 1801 I have laid out unto
 Henry House a tract of forty two acres of land
 in Spartanburgh Dist. on abners Creek
 water of Enoree river, running N. E. & S. E. Henry
 House's land, S. W. Joseph House's land, N. W.
 Demsey's land, and with such shape & marks as the above plat Represents,
 Survey 14th Sept^r 1801, James Wofford Ds
 Recorded 15th Oct^r 1801, —

