

155

Laid down by a scale  
of 10 Champs to an inch

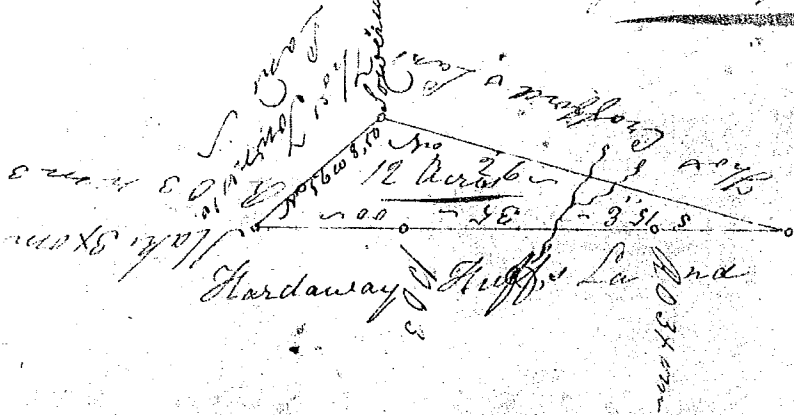

South Carolina

Pursuant to a warrant to John Young Esqr Commissioner of Locations for the District of Greenville, bearing date the 7th day of September 1818, I have caused to be advertised & laid out to Thomas Crofford a tract of twelve acres of Land on a small branch of Golden Groves Creek waters of Saluda River bounded by the said Thomas Crofford's Land running due North, to C. Thuff's line N 38 by Thomas Townes line, and has such found marks, bearings & bounding as the above Plat represents, Certified by me this 11th day of September 1818, B. Griffith Esq

Recorded the 14th day of Sept 1818

John Young CL

Delivered to S. Crofford