

(13)

20 Acres for each

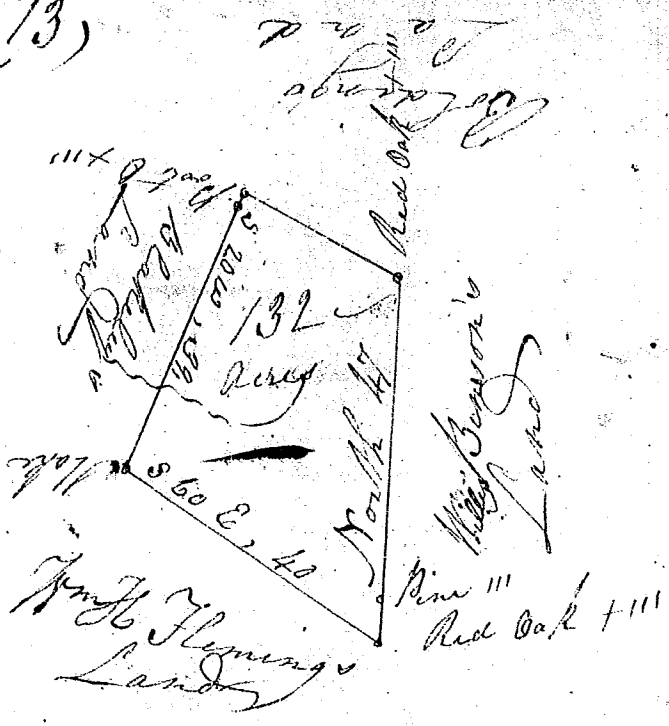

The State of South Carolina
 Greenville District. } I hereby certify
 that I have admeasured & laid out unto them-
 -phy Hall a tract, a tract or parcel of land having
 such shape and form as the above Plat represents
 and bounded on the east by lands belonging to Mills
 Binson, on the N^o by lands belonging to Bolden
 and on the W^t by Land of Blackley's, and on the
 S^W, by Land of Wm Fleming's; Laid Out this
 of October 1819. } Thomas Turner D^y

Recorded the 4th day of Nov^r 1819 by
 John Young Clerk
 handed to self