

17398 Filed This 27 day of Dec 1971
 And Recorded in Vol. 4M Page 33 of 1246
 Register Mesme Conveyance Greenville County, S. C.

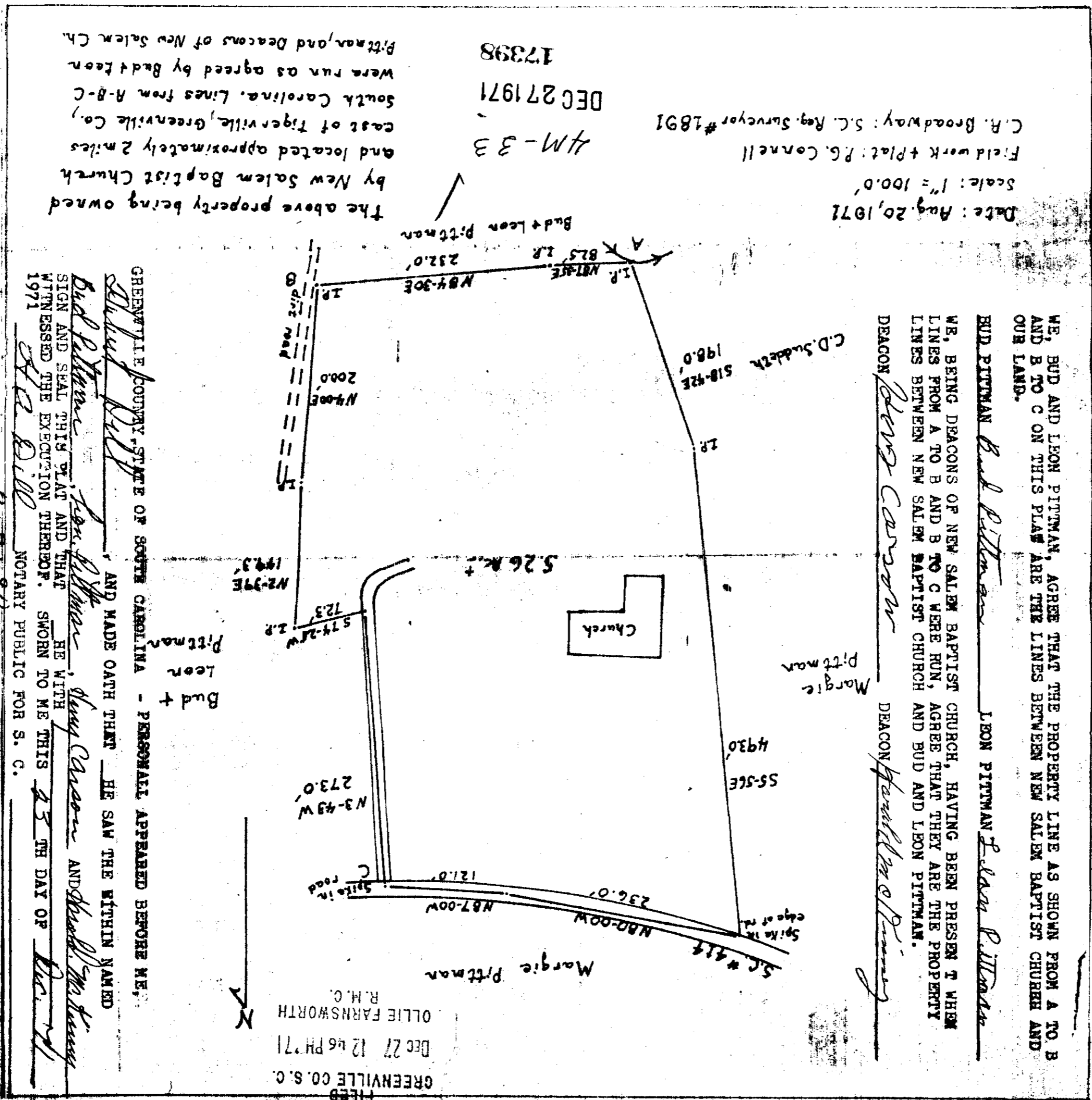

Date: Aug. 20, 1971
 Scale: 1" = 100.0'
 Field work + Plat: P.G. Connell
 C.R. Broadway: S.C. Reg. Surveyor #1891
 4M-33
 DEC 27 1971
 17398

The above property being owned by New Salem Baptist Church and located approximately 2 miles east of Tigerwille, Greenville Co., South Carolina. Lines from A-B-C were run as agreed by Bud + Leon Pittman, and Deacons of New Salem Ch.

WE, BUD AND LEON PITTMAN, AGREE THAT THE PROPERTY LINE AS SHOWN FROM A TO B AND B TO C ON THIS PLAT ARE THE LINES BETWEEN NEW SALEM BAPTIST CHURCH AND OUR LAND.

BUD PITTMAN *Bud Pittman*
 LEON PITTMAN *Leon Pittman*
 DEACON *Bud Carson*
 DEACON *Franklin Ramsey*

GREENVILLE COUNTY, STATE OF SOUTH CAROLINA
 AND MADE OATH THAT HE SAW THE WITHIN NAMED
 Bud Pittman, Leon Pittman, Bud Carson and Franklin Ramsey
 SIGN AND SEAL THIS PLAT AND THAT HE WITH SWORN TO ME THIS 25 TH DAY OF Dec. 1971
 Steve Bill
 NOTARY PUBLIC FOR S. C.

FILED
 GREENVILLE CO. S. C.
 Dec 27 12 46 PM '71
 OLLIE FARNSWORTH
 R.M.C.

MICROFILMED