

GREENVILLE, S. C.  
FEB 16 1 46 PM '71  
OLLIE FARNSWORTH  
R.M.C.

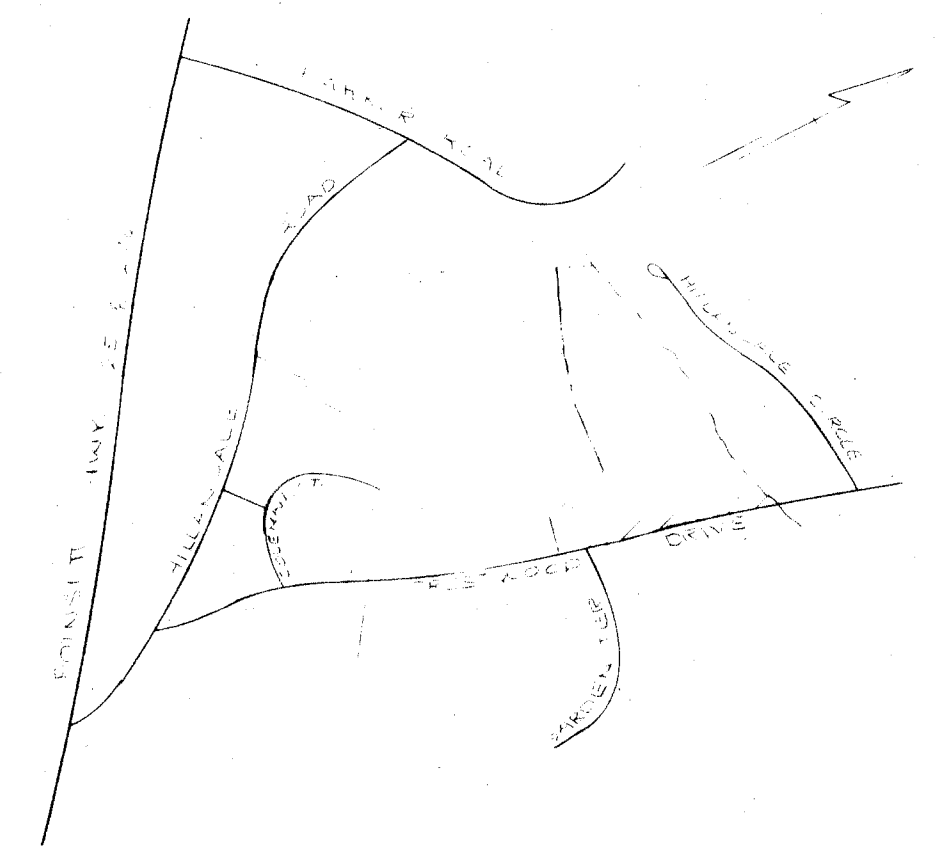

LOCATION MAP

CERTIFICATE OF OWNERSHIP AND DEDICATION

The undersigned hereby acknowledge that I am (we are) the owner(s) of the property shown and described hereon and that I (we) hereby adopt this plan of subdivision with my (our) free consent and that I (we) establish the minimum building restriction lines, and hereby dedicate to public use as roads, streets, and easements, forever all areas so shown or indicated on said plat.

1/28/71 Signed: *Don E. Bruce*  
Signed: \_\_\_\_\_  
Signed: \_\_\_\_\_  
Signed: \_\_\_\_\_

CERTIFICATE OF ACCURACY

"I, \_\_\_\_\_, certify that this plat was (drawn by me) (drawn under my supervision) (an actual survey made under my supervision) from (an actual survey made by me) (used description recorded in Book 266, Page 601, Book \_\_\_\_\_, Page \_\_\_\_\_, etc.) (other); that the error of closure as calculated by H. H. Adams and I departures is \_\_\_\_\_, that the boundaries not surveyed are shown as broken lines plotted from information found in Book \_\_\_\_\_, Page \_\_\_\_\_, that this plat was prepared in accordance with the Greenville County Subdivision Regulations as adopted.

1-28-71 Date Signed: *Jama D. Cain*  
Licensed Engineer or Registered Surveyor  
S. C. Registration No. 3320

CERTIFICATE OF APPROVAL FOR RECORDING

"I hereby certify that the subdivision plat shown hereon has been found to comply with the Subdivision Regulations for Greenville County, with the exception of such variances, if any, as are noted in the minutes of the Greenville County Planning Commission of Greenville County, South Carolina, and that it has been approved for recording in the office of the County Register of Mense Conveyance."

FEB. 10, 1971. Signed: *J. Clemon Shouse*  
Chairman, Greenville County Planning Commission

18938 Filed this 16 day of Feb. 1971  
And Recorded in Vol. 4N Page 3 of 196 P.  
*Ollie Farnsworth*  
Engineer of Mense Conveyance, Greenville County, S. C.

PERFORMANCE BOND POSTED FOR RECORDATION APPROVAL

No county street maintenance will be placed on any street shown on this plat until the release of this bond.

Released: \_\_\_\_\_  
19 \_\_\_\_\_ Director of Planning  
Greenville County  
Planning Commission

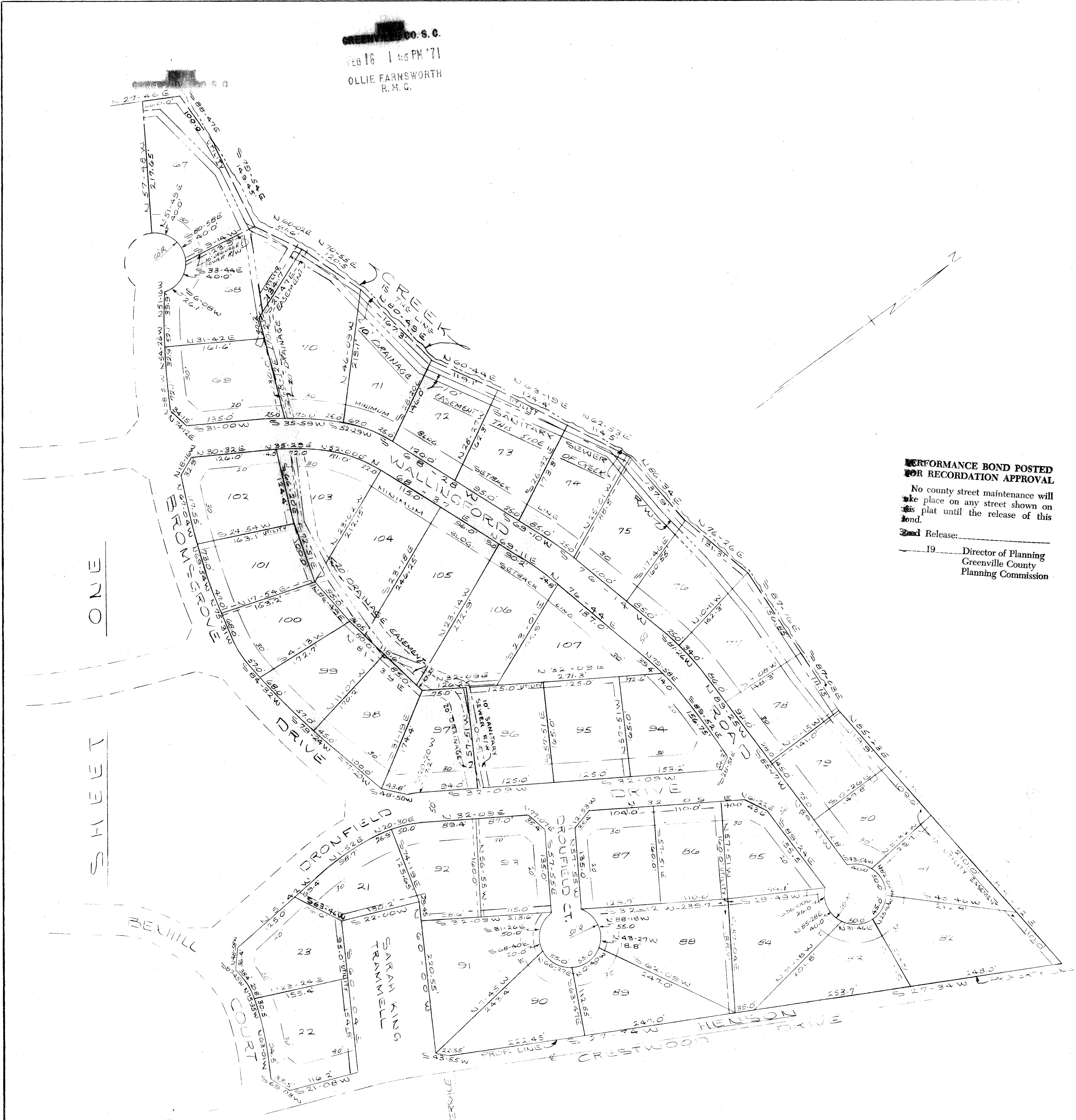

LEGEND  
--- 10' DRAINAGE EASEMENT (UNLESS OTHERWISE NOTED)  
--- 10' SANITARY SEWER ROW  
--- 10' UTILITY EASEMENT

ENGINEERS & ARCHITECTS  
DAN E. BRUCE, ETAL  
OWNER

NO. OF ACRES 21.25 VILLES OF NEW ROADS 1.48

NO. OF LOTS 107 DATE NOV. 5, 1970

PAYOR OF CLOSURE 1/3679

