

FILED
GREENVILLE CO. S. C.
MAR 2 4 14 PM '72
OLLIE FARRSWORTH
R. H. C.

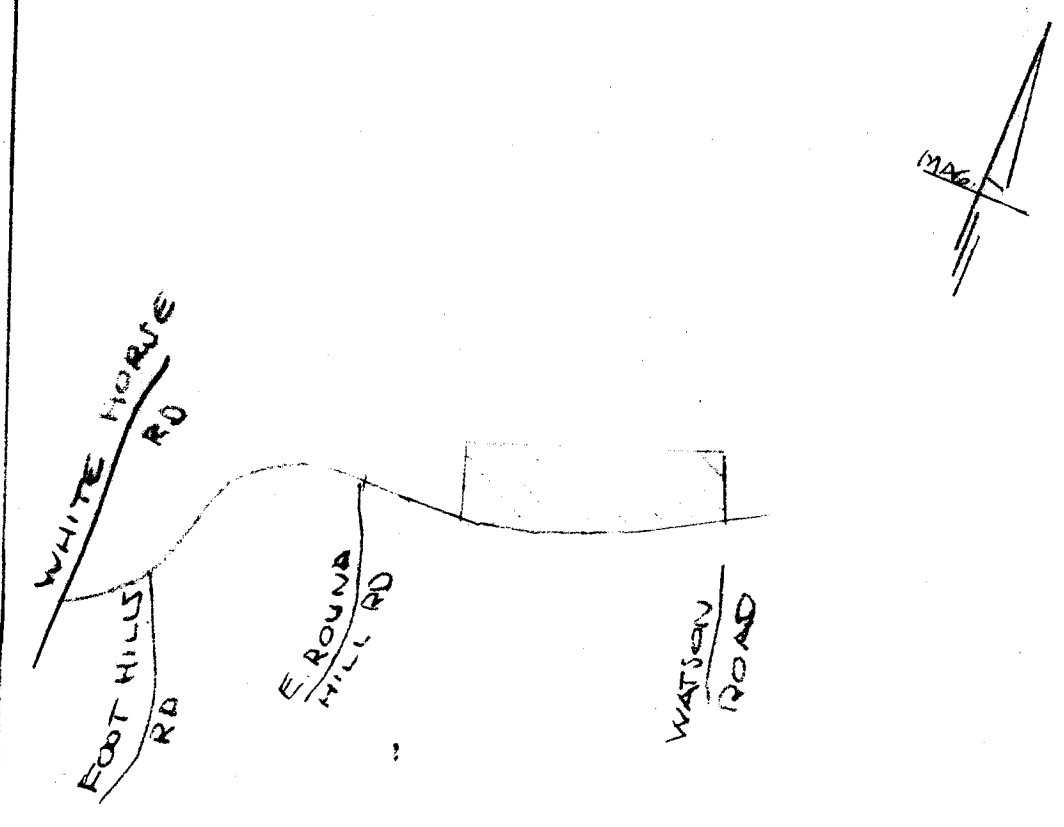

CERTIFICATE OF OWNERSHIP AND DEDICATION

"The undersigned hereby acknowledge that I am (we are) the owner(s) of the property shown and described hereon and that I (we) hereby adopt this plan of subdivision with my (our) free consent and that I (we) establish the minimum building restriction lines, and hereby dedicate to public use as roads, streets, and easements, forever all areas so shown or indicated on said plat.

2-29-72 Signed *W. J. Ferguson*
 Signed _____
 Signed _____
 Signed _____

CERTIFICATE OF ACCURACY

"I, _____, certify that this plat was (drawn by me) (drawn under my supervision) (an actual survey made under my supervision) from (an actual survey made by me) (deed description recorded in Book _____, Page _____, Book _____, Page _____, etc.) (other); that the error of closure as calculated by latitudes and departures is _____; that the boundaries not surveyed are shown as broken lines plotted from information found in Book _____, Page _____; that this plat was prepared in accordance with the Greenville County Subdivision Regulations as adopted.

2-29-72 Date *R. B. Bruce*
 Licensed Engineer or Registered Surveyor
 S. C. Registration No. 1952

SUMMARY APPROVAL

This plat meets the minimum requirements of the Greenville County Subdivision Regulations. Approval for recording is hereby granted.
 2/29/72 Date *J. Alan Jones*
 Director, Greenville County
 Planning Commission

FILE NUMBER 72-108

FINAL PLAT
CARAVELLE

BROWN ENTERPRISES OWNER	R. B. BRUCE REG. SURVEYOR
17 NO OF ACRES	0 MILES OF NEW RD.
6 NO OF LOTS	10 FEB 1972 DATE
ERROR OF CLOSURE:	

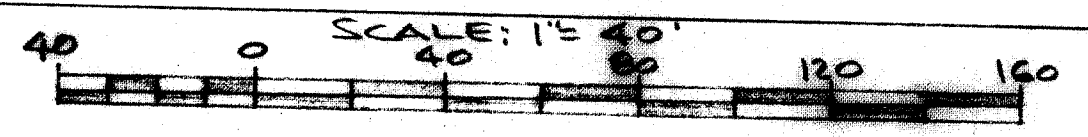

23555 Filed this 2d day of March 1972
 Recorded in Vol. 44 Page 64 at 4:14 P.
OLLIE FARRSWORTH
 Greenville County, S. C.

55.00
4N-61