

MICROFILMED

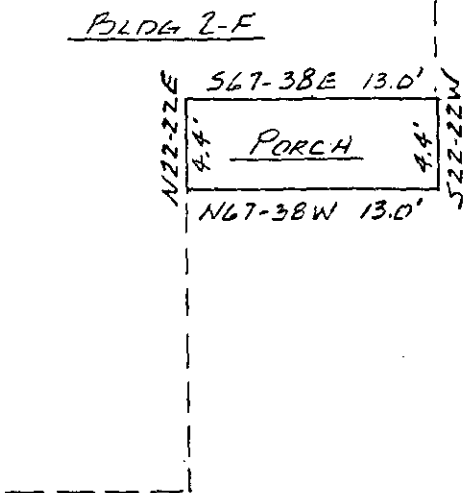
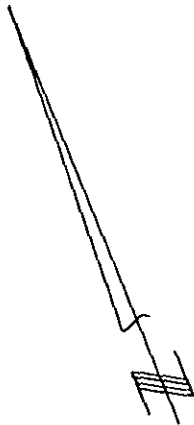

GREENVILLE COUNTY S.C.  
NOV 8 4 55 PM '82  
DONNIE S. TANKERSLEY  
R.M.C.

Greenville County  
South Carolina

Date: October 27, 1982  
Scale: 1" = 10'

PROPERTY OF: Delores J. Donaldson

This is to certify that on October 27, 1982, the property shown on this plat, being a parcel of land adjacent to Lot 2-F of WOODWIND TOWNHOUSES, PHASE II, as shown on plat recorded in the RMC Office for Greenville County in Plat Book 8-P, page 73, was surveyed under my supervision, and to the best of my knowledge the property lines are as shown thereon.

✓  
9I-13

11274

*Ronald E. Blackmore*  
Ronald E. Blackmore  
R.E.S. #52912  
GREENVILLE COUNTY S.C.  
SURVEYOR  
2 NOV 8 82 1288

3.00CI

 heaner engineering co., inc.  
greenwood, s. c.

GCTD

