

DUKE POWER COMPANY
NORTH GREENVILLE TIE STATION
REF DWG NO 153-137

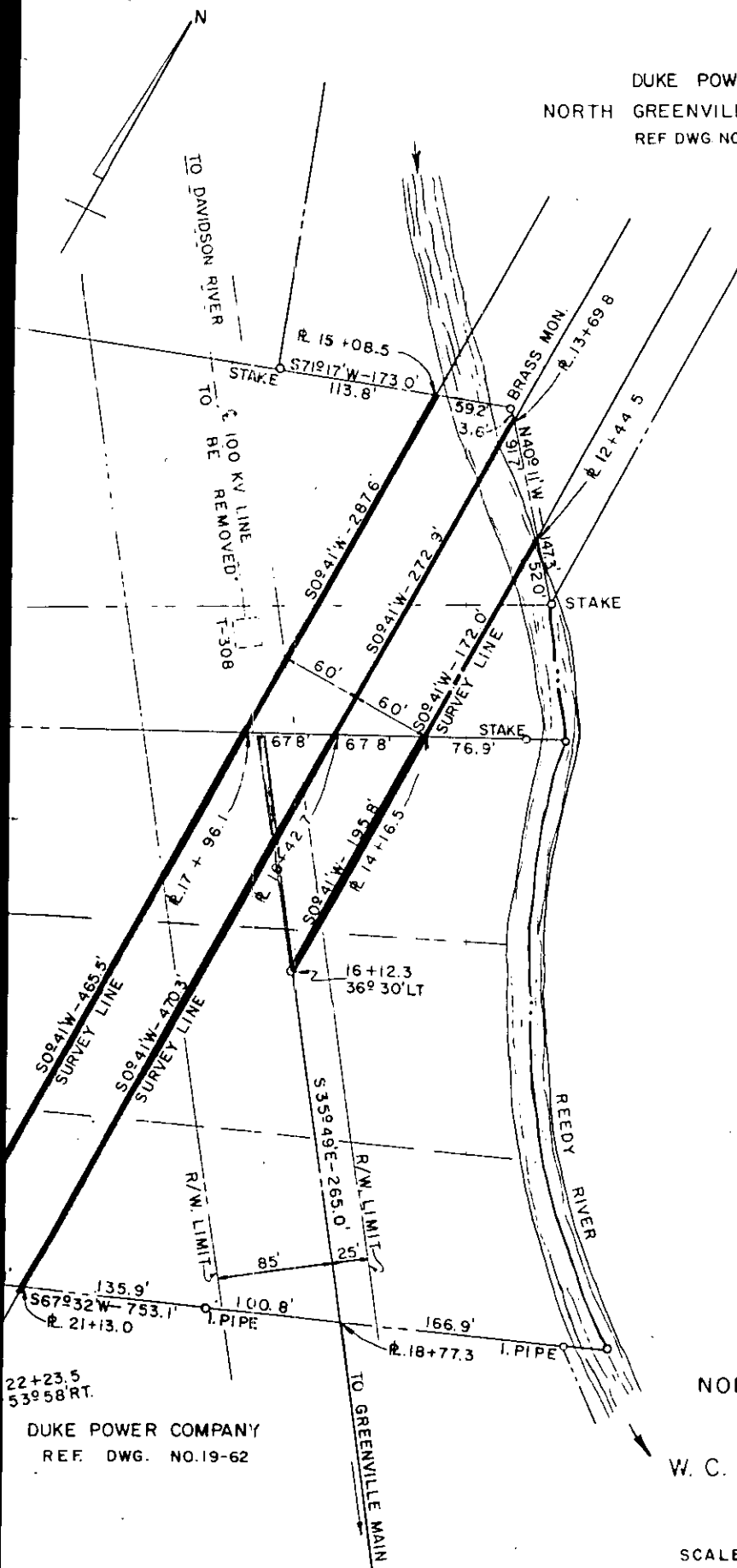

22+23.5
53°58 RT.

DUKE POWER COMPANY
REF. DWG. NO.19-62

DUKE POWER COMPANY
NORTH GREENVILLE FOLD-IN
TRANSMISSION LINES
CROSSING PROPERTY OF
W. C. WRIGHT & L. C. CROOKS
GREENVILLE TOWNSHIP
GREENVILLE COUNTY, S.C.

SCALE: 1" = 100'
BOOK NO 741

APRIL 15, 1964
FILE NO. 154-190