

19570

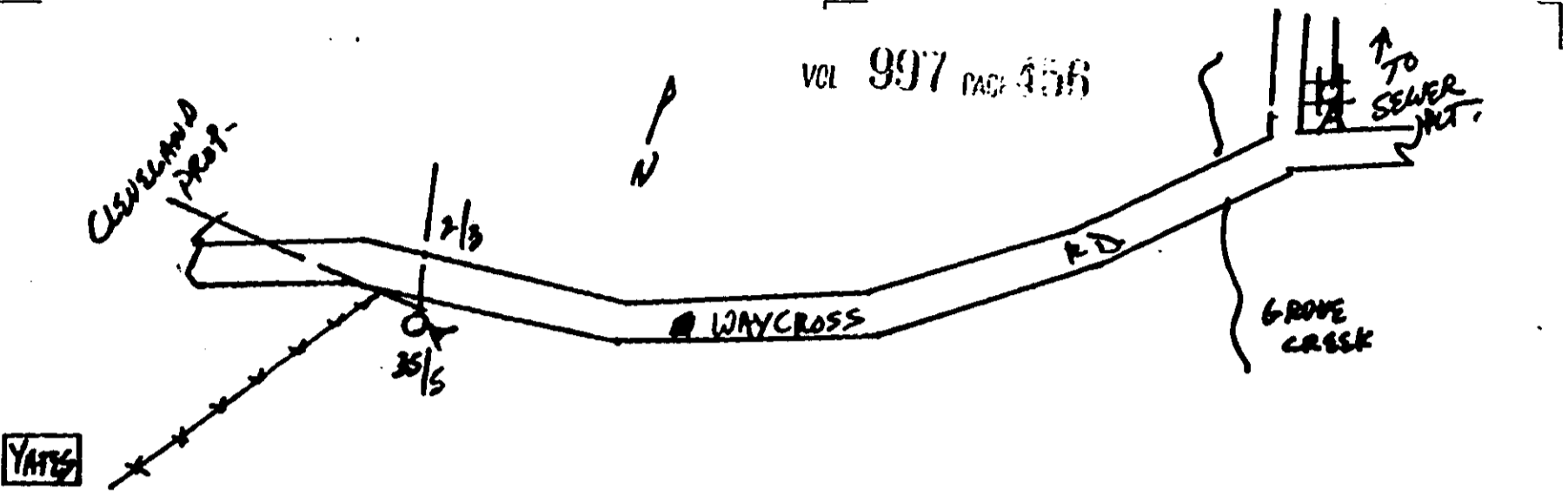

RECORDED APR 1974

26278

RECEIVED
 APR 19 1974
 26278
 454

19100 (360.2) XX

Ray Deems

TO

DUKE POWER COMPANY

RIGHT OF WAY

Ray

Filed for record in the office of
 the R. M. C. for Greenville
 County on April 11:00 o'clock
 A. M. April 19th 1974
 and recorded in Deed Book
 997 at page 155
 R. M. C. for G. Co. S. C.

Right of Way

4325 RV-2