

1344

Page 158

VOL 1105 PAGE 158

Tritor U.S.A., Inc.

NGS-34E - 2511'

Common Easement  
6,264 Sq. Ft.

NGS-34E - 2514.5'

1540'

"A"  
24,809.59 Ft.  
= 0.57 AC

"B"  
25,317.50 Ft.  
= 0.58 AC

Common Drive  
+ 524.26E 195'

ROAD

OLD HOWELL ROAD

HAYWOOD-HOWELL ROAD

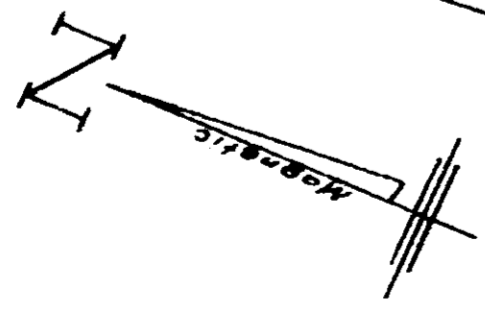

EAST NORTH STREET  
(OLD SPARTANBURG ROAD)

SURVEY FOR

TRITOR U.S.A., Inc.

GREENVILLE CO., S.C.

SCALE: 1" = 50'      OCT, 1978

Exhibit A

W. R. Williams, Jr.  
ENGINEER/SURVEYOR  
PE # L S No 9979  
15 S MAIN ST.  
TRAVELERS REST, S.C.

5413-1-PT 16

(CONTINUED ON NEXT PAGE)

4328 RV-2

0158