

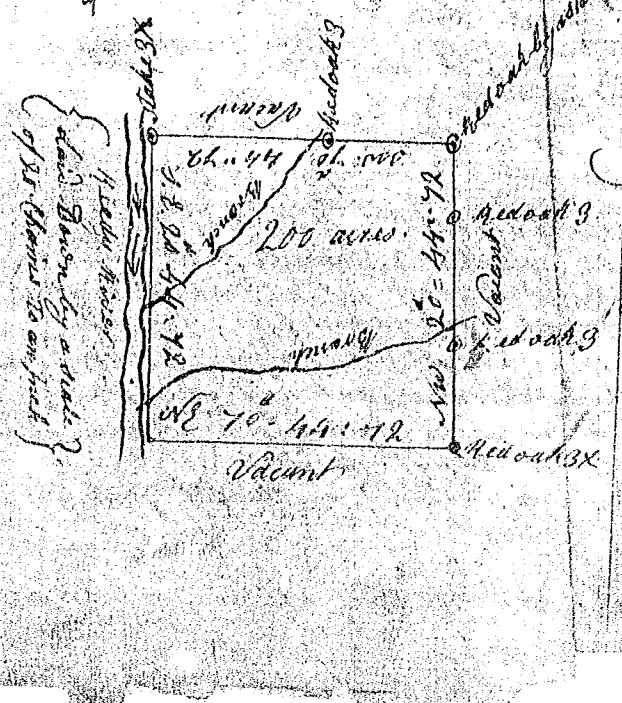

State of South Carolina
 Pursuant to a warrant
 to ~~John Thomas~~ John Thomas Esq. Commissioner of Locations dated 21st day of May 1784 I have admeasured and laid out unto James M. O'Harney a tract of land in the District of Ninety six containing Four Hundred acres Bound on all sides by Vacant Land and has such Shape form and marks as the above Plat represents
 Surveyed the 24th day of May 1784
 William Benson Esq.
 del. to Sam^l Earle



State of South Carolina
 Pursuant to a warrant from John Thomas Esq. Commissioner of Locations dated the 21st day of May I have admeasured and laid out unto John Gowin a tract of land containing Four hundred acres, in the District of Ninety six, on the Middle fork of Saluda, and hath such shape and marks as the plat represents
 Surveyed the 25th day of May 1784
 William Benson Esq.
 del. to Capt Wm Smith



South Carolina
 Pursuant to a warrant to me directed by the hand and seal of John Thomas Esq. Commissioner of Locations for the district of Ninety six, North of Saluda I have admeasured and laid out unto George Martin a tract of land containing two hundred acres situate lying & being on the North side of Saluda river on the North bank of Meedy River. Bound on the West and North all other sides on vacant land and hath such shape form and marks as the above Plat represents
 Surveyed the 29th day of May 1784
 Surveyed the 29th day of May 1784
 Wm Lewis Esq.
 del. and related to