

State of South Carolina

(110)

Pursuant to a warrant from John Thomas Esq. Commissioner of Locations Dated May the 22^d 1784 I have admeasured and laid out unto William Poole a Tract of Land containing Two hundred acres situate in Ninety six District west of the old Indian Boundary, on both sides of Mush Creek of Tyger River Bounded on all sides on Vacant Land and hath such form and Marks as the above Plat Represents

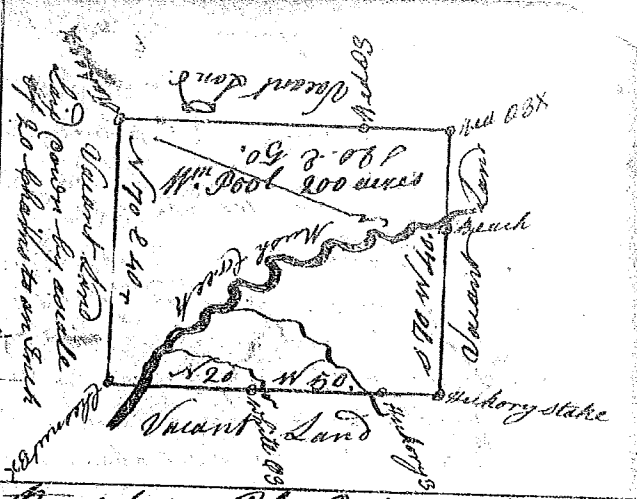

Recorded the 2^d day Aug. 1784

I Surveyed the 22 day of June 1784

George Salmon D.S.

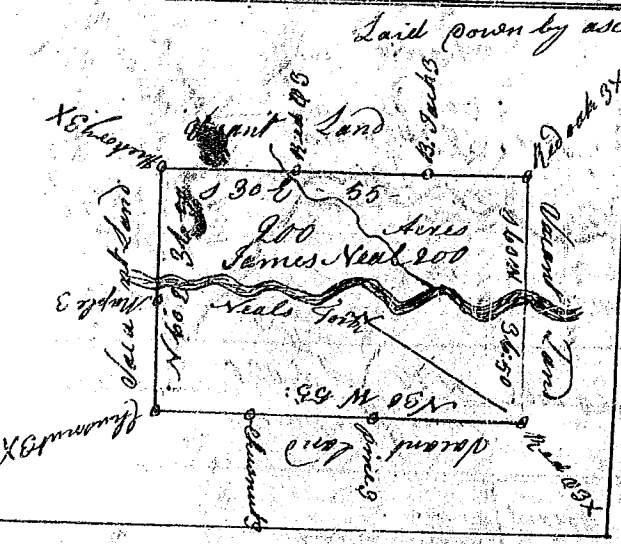

Laid down by a scale of 20 Chains to an Inch

State of South Carolina

Pursuant to a warrant from John Thomas Esq. Commissioner of Locations dated May 24th 1784 I have admeasured and laid out unto James Neal a Tract of Land containing Two hundred acres situate in Ninety six District west of the old Indian Boundary on both sides of Neal's Fork of Tyger River Bounded on all sides on Vacant Land, and hath such form and Marks as the above plat Represents

Surveyed the 19th of June 1784

Geo. Salmon D.S.

Recorded the 2^d Aug. 1784

State of South Carolina

Pursuant to a warrant from John Thomas Esq. Commissioner of Locations dated May 24th 1784 I have admeasured and laid out unto John Collins a Tract of Land containing Two hundred and five acres situate in Ninety six District west of the old Boundary line on both sides of South Tyger River Bounding on the SW on lands laid out unto Holt Goodlet Jr. all other sides on Vacant Land and hath such form and Marks as the above plat Represents

Surveyed the 21st Day of May 1784

George Salmon D.S.

Recorded the 2^d day of August 1784

