

State of South Carolina

Pursuant to a warrant from John Thomas Esq^r Commissioner of Locations dated May the 21st 1784 I have admeasured and laid out unto Joseph Wofford a tract of one hundred acres of land situate in ninety six district on Patersons Branch waters of the North fork Saluda Bounding S.E. on land laid out to Robert Henderson and on all other sides on Vacant Land, and hath form and shape as the about plot represents.

Surveyed the 29th day of May 1784
Recorded the 9th day August 1784
W^m Benson D^s

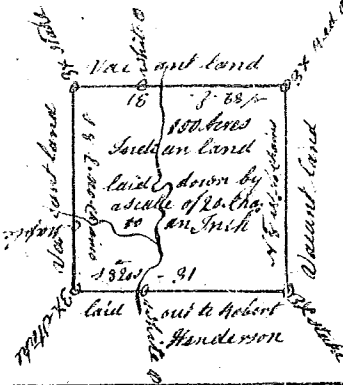

State of South Carolina

Pursuant to a warrant from John Thomas Esq^r Commissioner of Locations dated the 21st day of May 1784 I have admeasured and laid out unto Stacy Cooper a tract of one Hundred and forty four Acres land situate in Ninety six district on Bever dam Creek of the North Branch Bounding S.W. on land laid out to Malph Smith Esq^r and on all other sides on Vacant Land and hath shape and Markes as the above plot represents.

Surveyed the 19th July 1784
Recorded the 9th day August 1784
W^m Benson D^s

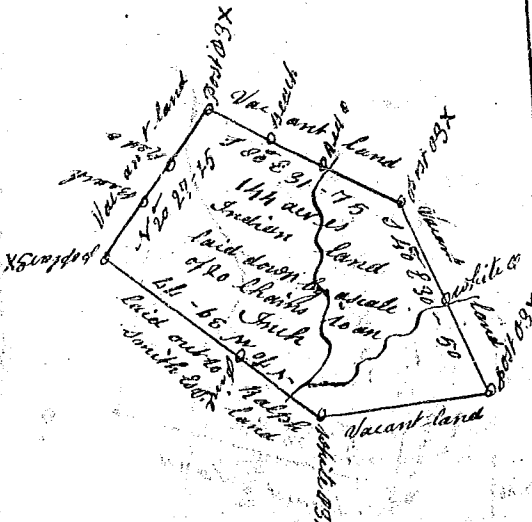

State of South Carolina

Pursuant to a warrant from John Thomas Esq^r Commissioner of Locations dated 21st day of May 1784 I have admeasured and laid out unto John Mollin a tract of two hundred and fifteen acres situate in Ninety six district on Cheseroe River about half a mile above town house Bound. N.E. on land laid out to Gabriel Moffett and on all other sides on Vacant Land, and hath such shape and Markes as the above plot represents.

Surveyed the 17th day of July 1784
Recorded the 9th day August 1784
W^m Benson D^s

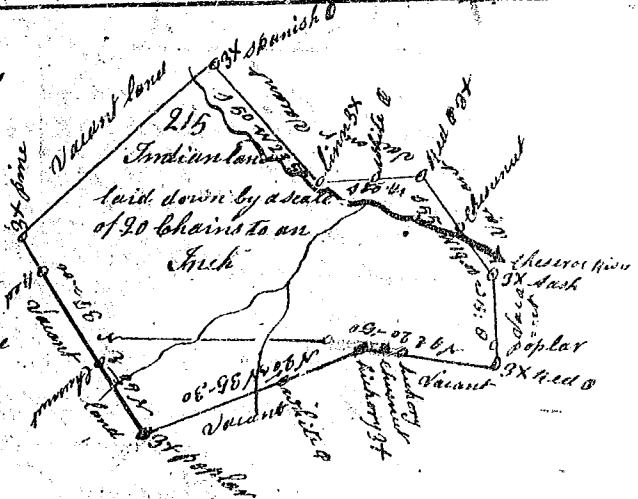

State of South Carolina

Pursuant to a warrant to me directed by John Thomas Esq^r Commissioner of Locations for the district of the North side of Saluda River I have surveyed and laid out unto Henry Hays a tract of land containing 202 acres situate lying and being above the old Indian boundary on both sides of Honey Creek a branch of Enorel River Vacant Land on every side, and hath such shape and Markes as the above plot represents.

Surveyed and Certified by me the 15 June 1784
Jas Seaborn D^s
Recorded the 15th day of August 1784

