

State of South Carolina

86

Pursuant to a warrant from John Thomas Esq. Commissioner of locations dated the 27th day of May 1784 I have measured and laid out unto Joseph Duncan a tract of one hundred and three acres land situate in Ninety Six district on the branches Saluda River and a branch of Steady River bounding to the S. and S.W. on land laid out to Charles Benson, and on all other sides by Vacant Land, and hath such shape and marks as the above plat represents.

Surveyed the 27th day June 1784

Recorded the 10th day August 1784 J. Benson D.S.

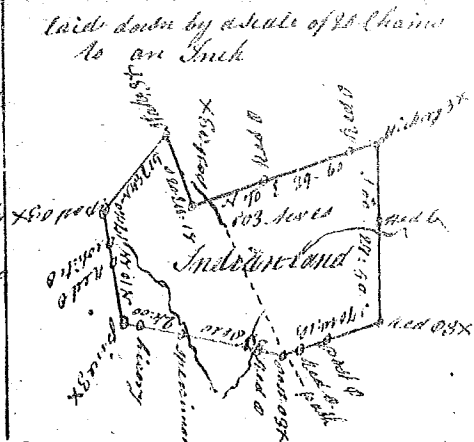

State of South Carolina

Pursuant to a warrant to me directed by John Thomas Esq. Commissioner of locations for the district of the North side Saluda River I have surveyed and laid out unto Potam Johnson a Tract of Land Containing 200 acres Situated Lying and being Below the Antient Boundary line on the waters of lawsons fork of Pacolet known by the name of Griffiths Improvement Bounded on the north by Rebecca Woods Land and on the S.E. by William Woods Land every other side by Vacant, and has such shape and marks as the above plat represents

Surveyed by me the 20th July 1784 Jas. Scarborough D.S.

Recorded the 10th day of August 1784

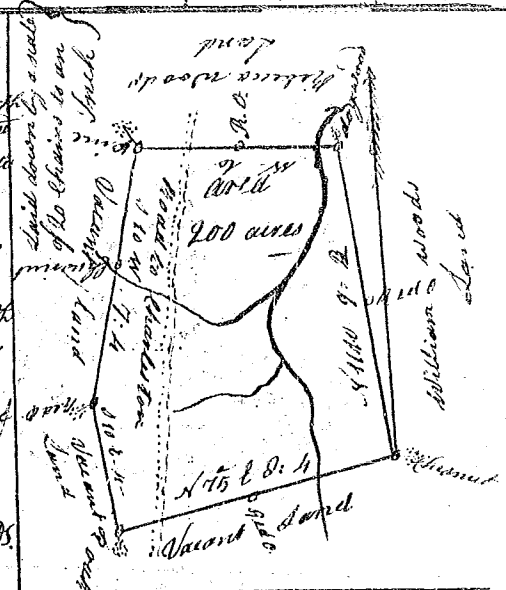

State of South Carolina 96 Dist.

Pursuant to a warrant to me directed by John Thomas Esq. Commissioner of Locations for the District of North side of Saluda River I have surveyed and laid out unto Benjamin Rice a tract of land containing 400 acres Situated Lying and being above the Antient boundary line on the waters of Grove Creek a branch of Saluda River Bounded on the S.W. by James Scarboroughs land all other sides Vacant and hath such shape and marks as the above plat represents Surveyed by me the 22nd day of May 1784

James Scarborough D.S.

Recorded the 10th of August 1784

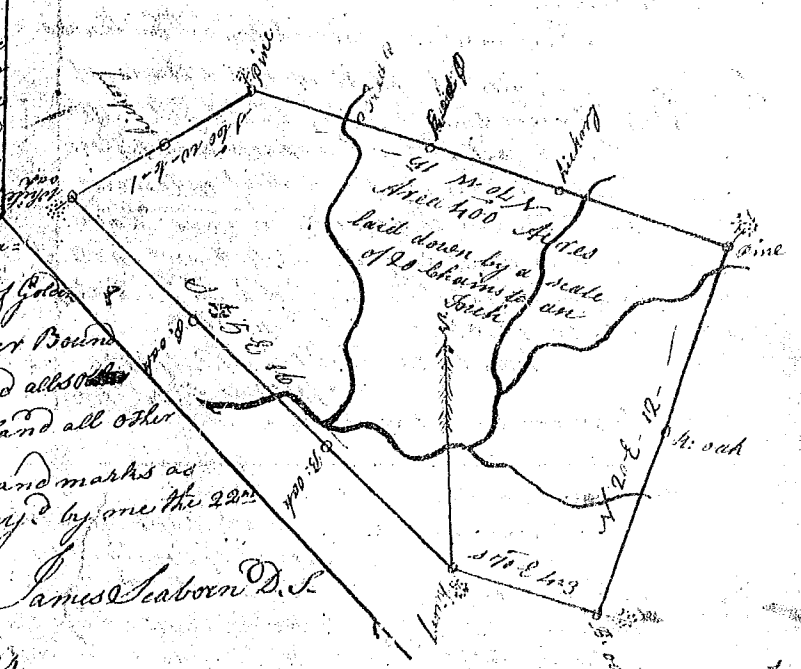

State of South Carolina 96 Dist.

Pursuant to warrant to me directed by John Thomas Esq. Commissioner of Locations for the District of the north side of Saluda river I have surveyed and laid out unto Thomas Woods a tract of land containing 100 acres Situated Lying and being above the Antient Boundary line on a branch of the Middle fork of Saluda Vacant land on every side and hath such and marks as the above plat represents Surveyed by me the 19th July 1784

Recorded the 10th of August 1784 Jas. Scarborough D.S.

