

State of South Carolina

(119)

Pursuant to a warrant from John Thomas Esq. Commissioner of Locations dated the 18<sup>th</sup> of August 1784, I have admeasured and laid out unto John Foster a Tract of Land containing Two Hundred acres Situated in Ninety Six District East of the old Indian Boundary, on both sides of Peoples Creek of Broad River, Bounding N.W. on land laid out to George Taylor, all other sides on Vacant Land and hath such shape and marks as the annexed Plat Represents. Surveyed the 7<sup>th</sup> day of Sept<sup>r</sup> 1784 -  
Recorded the 23<sup>rd</sup> of Sept<sup>r</sup> 1784 -

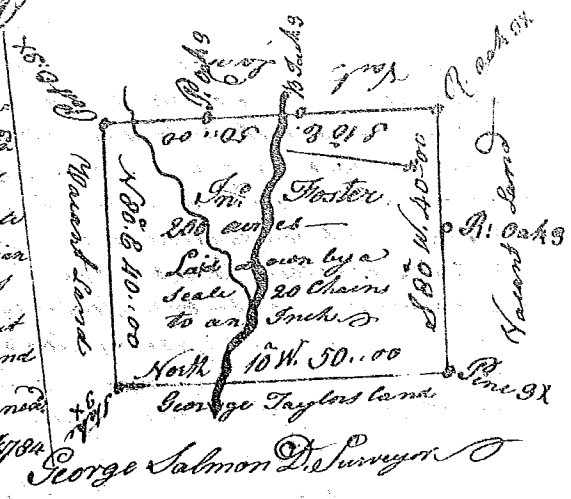

George Salmon D. Surveyor

State of South Carolina

Pursuant to a Warrant from John Thomas Esq. Commissioner of Locations Dated this 1<sup>st</sup> day of June 1784, I have admeasured and laid out unto Obadiah Oliphant a Tract of Land containing Two Hundred acres Situate in Ninety Six District East of the old Indian Boundary on both sides of Thickety Creek & Goose Creek Waters of Broad River Bounding W on Browns land & N.W. on W<sup>m</sup> Williams Land, all other sides Vac. Land and hath such shape form and marks as the above Plat Represents. Surveyed August 21<sup>st</sup> 1784  
Recorded the 23<sup>rd</sup> of Sept<sup>r</sup> 1784



George Salmon D. Surveyor

State of South Carolina

Pursuant to a warrant from John Thomas Esq. Commissioner of Locations dated 7<sup>th</sup> June 1784, I have admeasured & laid out unto John Hughey Esq. a Tract of 200 acres of land Situate in Ninety Six District on the waters of Sugar River bounding S.E. on Vacant Land, laid out to John Hughey N.W. & N.E. on land laid out to Sam<sup>l</sup> White N.W. on Vacant Land S.W. on land laid out to Sam<sup>l</sup> Young and John Hughey and hath such shape and Marks as the annexed Plat Represents. Surveyed the 26<sup>th</sup> Aug<sup>t</sup> 1784  
Recorded 24<sup>th</sup> Sept<sup>r</sup> 1784

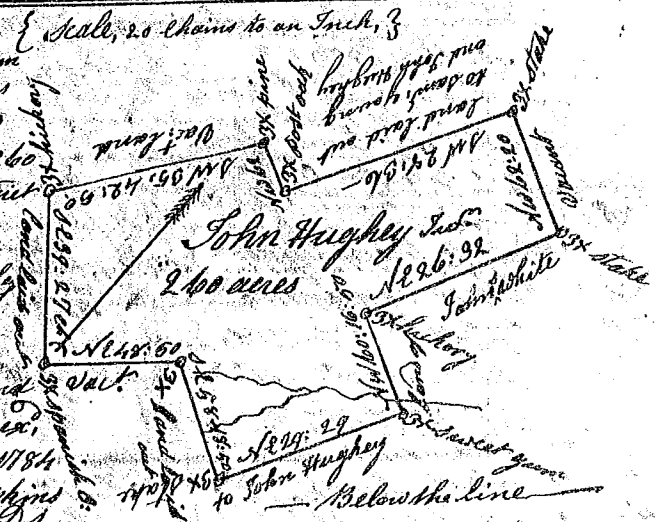

David Hopkins D.