

State of South Carolina, Ninety six District on the east of the ancient boundary line

Pursuant to a warrant from John Thomas Esq. Commissioner of Locations dated 24 July 1784, I have admeasured and laid out unto John Alexander a tract of Land containing one Hundred and Seventy one acres lying and being on the North side of the South fork of Tyger River, to the South by said River all other sides Vacant Land, and hath shape and Marks as the annexed Plat represents

Surveyed the 9th Sept. 1784 And: Thomson D.
Recorded 25 Sept. 1784

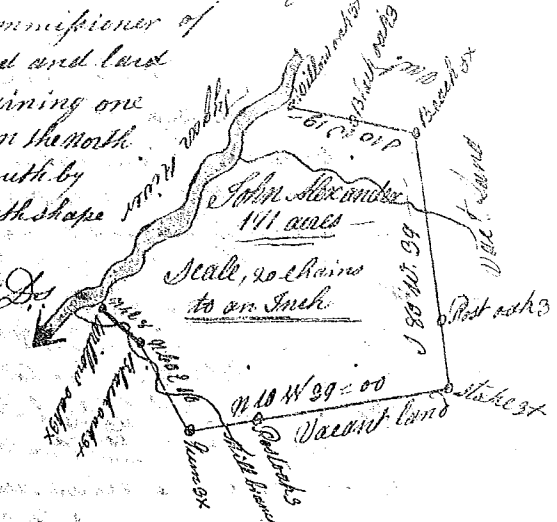

State of South Carolina, Ninety six Dist. on the East of the ancient boundary line

Pursuant to a warrant from John Thomas Esq. Commissioner of Location dated the 24th day of July 1784 I have admeasured and laid out unto James Fearis a tract of Land containing two Hundred acre lying on a small branch of Dutchmans Creek bounded to the west by Vacant land to the N by Edward Lauridsen land to the east by Vacant land to the S by John Elders Land, and hath such shape and Marks as the annexed Plat Represents

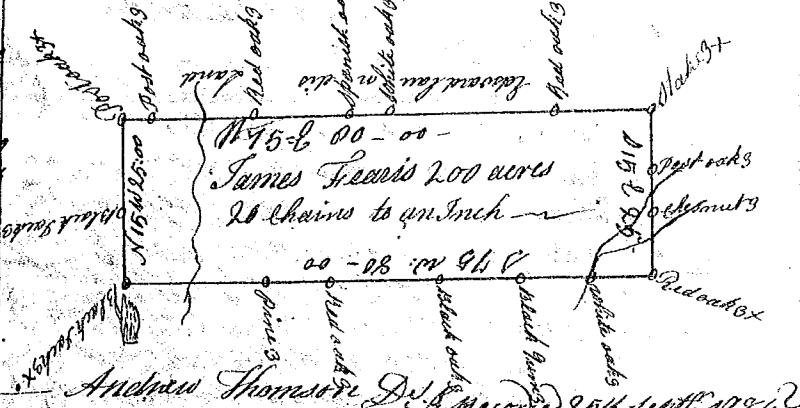

State of South Carolina, Ninety six district on the East side of the ancient boundary line

Pursuant to a warrant from John Thomas Esq. Commissioner of Location dated the North side Saluda 22nd May 1784, I have admeasured and laid out unto Arthur Crocker a tract of Land containing Two hundred and fifty acres lying and being on a small branch of Richland Creek bounded on all sides by Vacant Land, and hath such shape and Marks as the annexed plat represents, Surveyed 10 July 1784

Recorded 25 Sept. 1784 Andrew Thomson D.

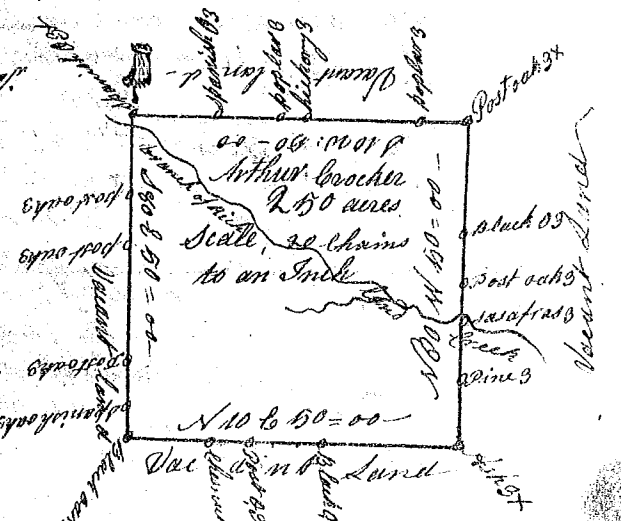

State of South Carolina, Ninety six District East of the ancient boundary line

Pursuant to a warrant from John Thomas Esq. Commissioner of Location dated 11th day of June 1784 I have admeasured and laid out unto James Keen a tract of land containing two hundred and fifty acres lying on a small branch of Spinforest called the Keely branch - bounded to the S by Meehard Stambertons land to the W by Old lines to the N by Vacant land to the E by Roland Cornelias land and hath such shape and Marks as the annexed plat Represents

Surveyed the 3 day Aug. 1784
Recorded 27 Sept. 1784 Andrew Thomson D.

