

State of South Carolina 96 District
 Pursuant to a warrant from John Thomas Esq.
 Commissioner of Locations on the north side of Saluda
 River dated the 9th October 1784. I have admeasured &
 laid out unto James Vernon a Tract of Land contain-
 ing Two Hundred & Seventy acres lying on Folsom's
 Branch of Middle Sugar River, Bounded N. by John
 Hemch N. by Thomas Vernon All other sides Vacant
 and hath such shape & marks as the annexed plat
 Represents. Survey^d 11th Oct. 1784
 Recorded the 25th days of October 1784
 Andrew Morrison Esq.

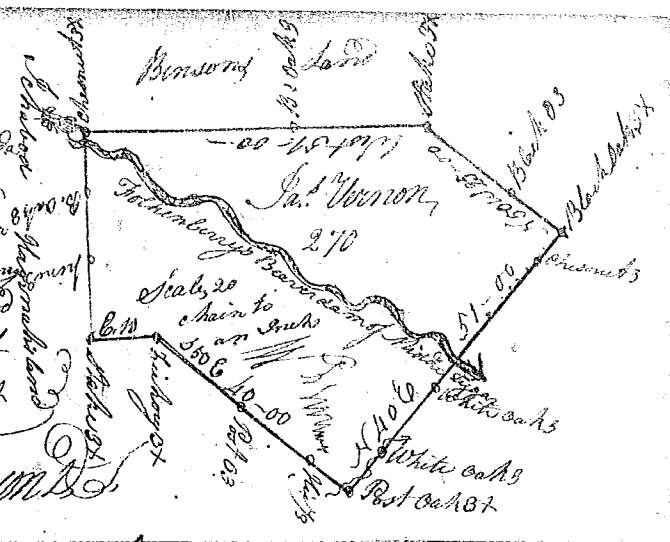

State of S. Carolina Ninety Six Dis^{trict}
 Pursuant to a warrant from John
 Thomas Esq. Commissioner of Locations
 for the North side of Saluda River, dated
 the 9th Oct. 1784. I have admeasured & laid
 out unto John Nicoll, Junr. a tract of Land
 containing three hundred & eighty nine
 acres lying on both sides of Bush Creek
 of S. Sugar River, Bounding E. & W. by
 John Nicoll, Junr. All by Thomas Doeg
 All other sides Vacant. & hath such
 shape and marks as the annexed plat
 Represents. Survey^d this 11th October 1784
 Recorded the 25th days of October 1784
 Andrew Morrison Esq.

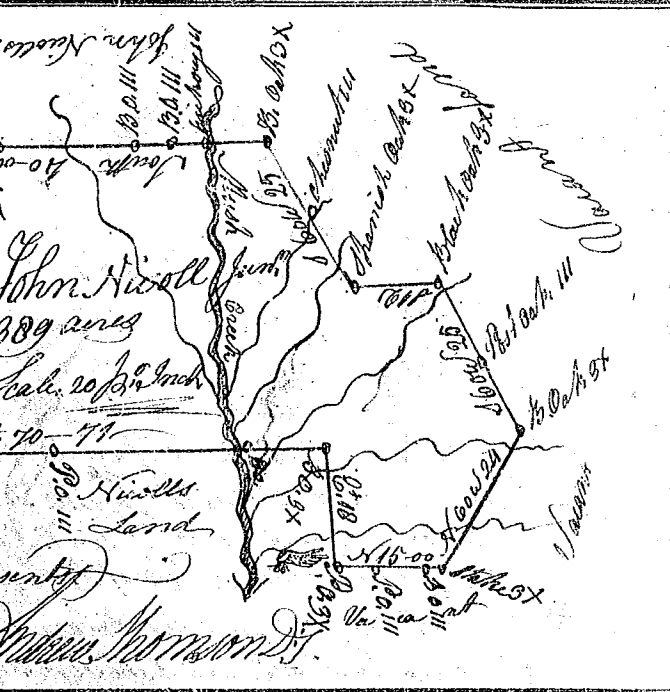

State of S. Carolina 96 District West of the ancient
 Boundary Pursuant to a warrant from John
 Thomas Esq. Com^{rs} Locations for the north side of Saluda
 River, dated the 9th of October 1784. I have admeasured
 and laid out unto Thomas Doeg a Tract of Land
 containing 200 acres lying on the
 Branches of Bush Creek, Bounded N.E. by John
 Nicoll Junr. & all other sides Vacant. & hath such
 shape & marks as the annexed plat Represents
 Survey^d this 11th Oct. 1784
 Recorded the 25th days of Oct. 1784
 Andrew Morrison Esq.

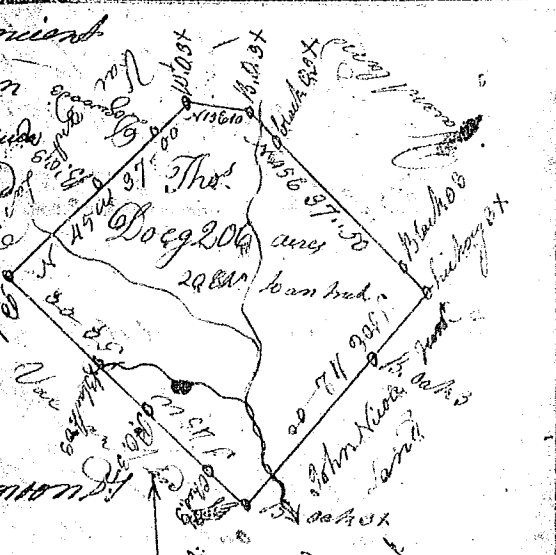

South Carolina Pursuant to a warrant from John Tho-
 mas Esq. Co. in the District of 96 No of Saluda River
 I have surveyed and laid out unto Nathan Williams a tract
 of one hundred and fifty acres of Land situate on Cry-Creek
 a branch of Bush River Land District aforesaid, Bounding on
 all sides on Vacant Land not laid out Having such form
 and Marks as the annexed plat Represents Survey^d 20th Sept. 1784
 Recorded 1st Nov. 1784
 Phil. Pearson Esq.

