

State of South Carolina,

Pursuant to a warrant from John Thomas Esq. Commissioner of Locations for Ninety Six District North Side Saluda River dated 15th July 1784, I have admeasured and laid out unto John Williams a tract of Six hundred and forty acres of Land Below the ancient Boundary on waters of Enoree, binding S.E. & E on James Head and John Head, all other sides on Vacant land, and hath such shape and Marks as the annexed Plat represents Surveyed the 26th July 1784

Phil. Waters Esq.

Recorded 1st Decr 1784

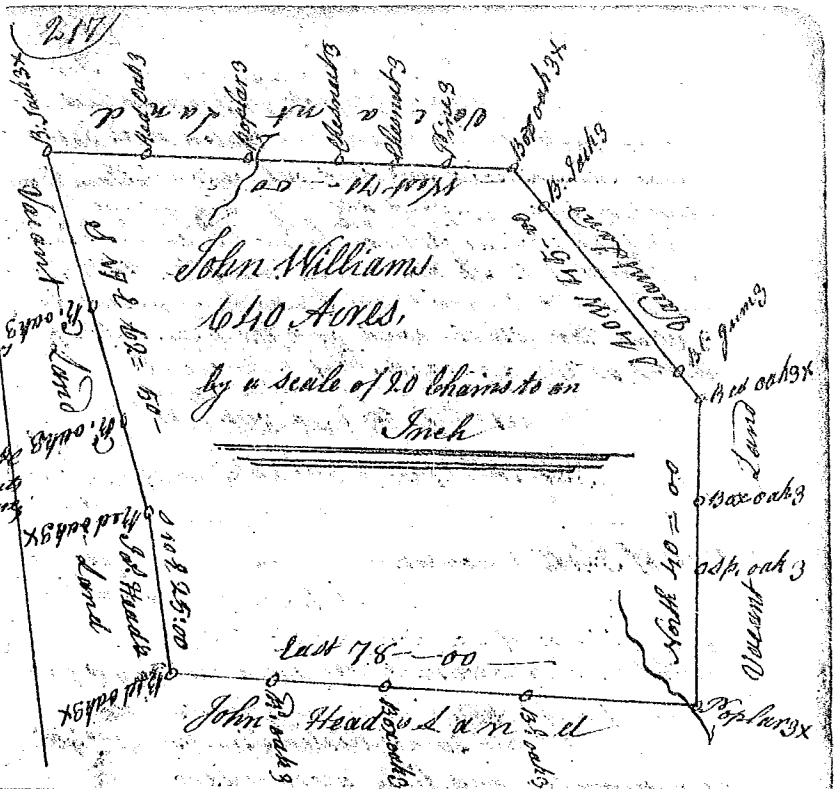

State of South Carolina

Pursuant to a warrant from John Thomas Esq. Commissioner of Locations for Ninety Six District No. of Saluda River dated 15th July 1784, I have admeasured and laid out unto John Head a tract of Six hundred and forty acres of Land below the ancient boundary on waters of Enoree binding NW on John Williams Land SE and SW on James Head's Land, and S.E. & E on James Head's Land, all other sides on Vacant Land & Lands unknown, and hath such shape and Marks as the annexed Plat represents Surveyed the 26th July 1784

Phil. Waters Esq.

Recorded the 4th Day Decr 1784

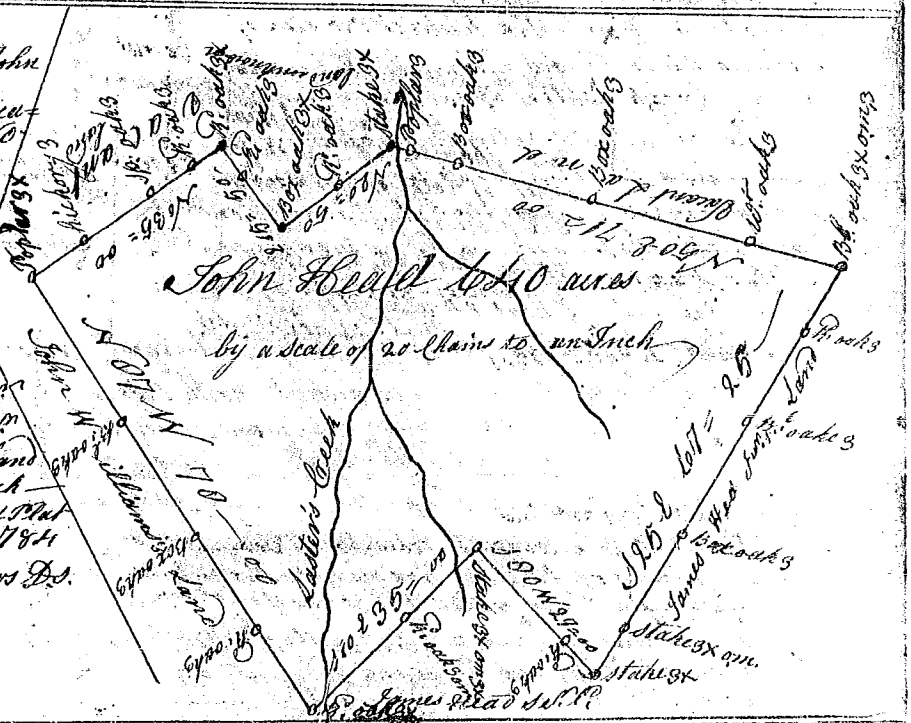

State of South Carolina.

Pursuant to a warrant from John Thomas Commissioner of Locations for Ninety Six District North Side Saluda, dated 15th Octr 1784, I have admeasured and laid out unto William King a tract of Two hundred acres of land situate in Ninety Six District North of Saluda River below the ancient boundary on waters of the Reservoir Corn waters of Saluda River Bounded S.E. on James Connelly's land SW on land of Henry Gold and William Gold NW & NE on Vacant land, and hath such shape and Marks as the annexed Plat represents

Surveyed 15th Octr 1784

Phil. Waters Esq.

Recorded 1st Decr 1784

