

State of South Carolina,

(218)

Pursuant to a warrant from John Thomas Esq. Commissioner of Locations for Ninety six District North Side of Saluda River dated the 21 day July 1784 I have admeasured and laid out unto James Head Jr. a tract of five hundred and seventy four acres of land below the ancient Boundary on waters of Inoree bounding N & E on John Head's land and P. waters land, N & W on P. waters land & S on John Head's land W & S on William Handricks land & N & S on vacant land and hath such shape and Marks as the annexed Plat Represents,

Surveyed the 25 July 1784

Phil. Waters Esq.

Recorded 1st Decr 1784

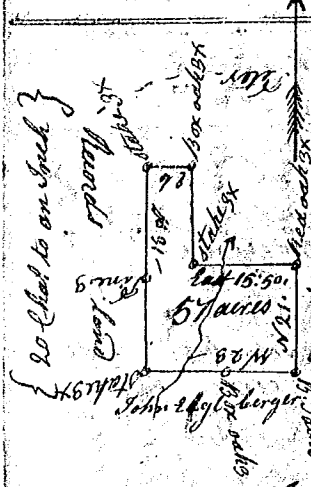
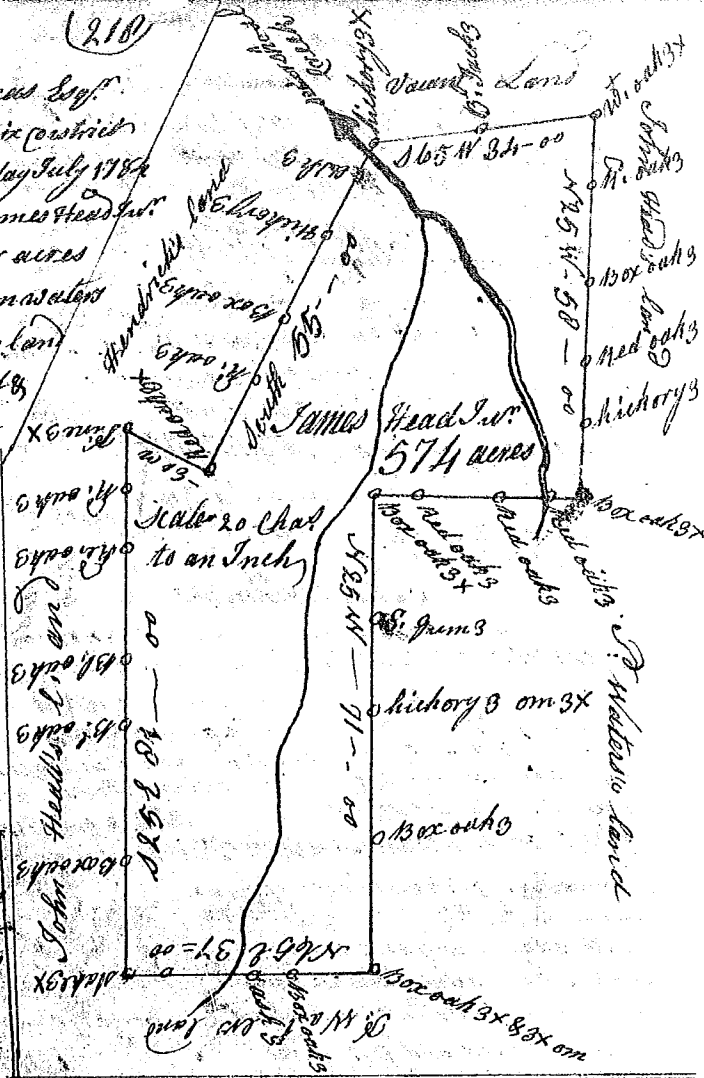

State of South Carolina,

Pursuant to a warrant from John Thomas Esq. Commissioner of Location for Ninety six District No. of Saluda dated the 16th Sept. 1784. I have admeasured and

laid out unto John Egleburger a tract of fifty seven acres of land situate in Ninety six District North side of Saluda River, below the ancient boundary on the waters of Eyman's Creek bounded on the N & E by Peter Perior's land on the south by J. Egleburger's land, on west by Vacant land, and hath such shape and Marks as the annexed Plat Represents

Surveyed the 2. day of October 1784

Recorded the 2. day of Decr 1784

Phil. Waters Esq.

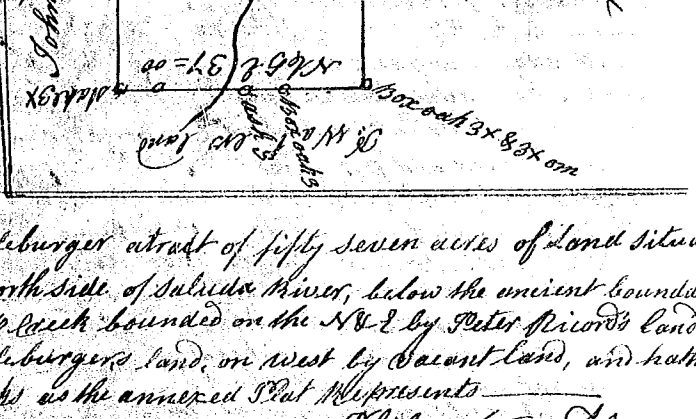

State of South Carolina

Pursuant to a warrant from John Thomas Esq. Commissioner of Location for Ninety six District North side Saluda River dated 22 July 1784, I have admeasured and laid out unto Abel Inoco a tract of one hundred acres of land situate in Ninety six District North side Saluda River below the ancient boundary on waters of Bush River bounded on the N & W. Marmaduke Cobbs land, on the W by Thomas Pearson's land, all other sides by vacant land, and hath such shape and Marks as the annexed Plat Represents, Surveyed the 28. day of Sept. 1784. Phil. Waters Esq.

Recorded the 2. day Decr 1784

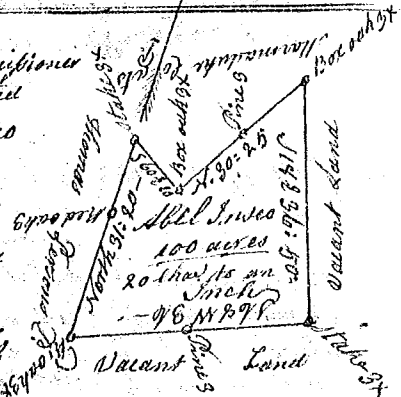

State of South Carolina

Pursuant to a warrant from John Thomas Esq. Commissioner of Location for Ninety six District No. of Saluda river, dated the 23. day of August 1784. I have admeasured and laid out unto John Waits a tract of one hundred acres of land, situate in Ninety six District North side Saluda River below the ancient boundary on a branch of Hawlish Creek waters of Saluda River, bounded on all sides by vacant land, and hath such shape and Marks as the annexed Plat Represents, Surveyed 21 Sept. 1784

Recorded 3. day Decr 1784

Phil. Waters Esq.

