

State of South Carolina,

224

Pursuant to a warrant from John Thomas Esq^r Commissioner of Locations I have admeasured and laid out unto Joshua Palmore a tract of 380 acres of Land situate in Ninety six district on the waters of Broad River Bounding NE on Mr. Brown NW on land laid out to Henry M. Givens SW & SE on land laid out SW on land laid out SE on land laid out to Mich^l Adis SE & SW on Mich^l Adis and hath such shape and Marks as the annexed Plat represents. Surveyed the 20th day of Aug^t 1784

Recorded the 6th Dec^r 1784

David Hopkins Esq

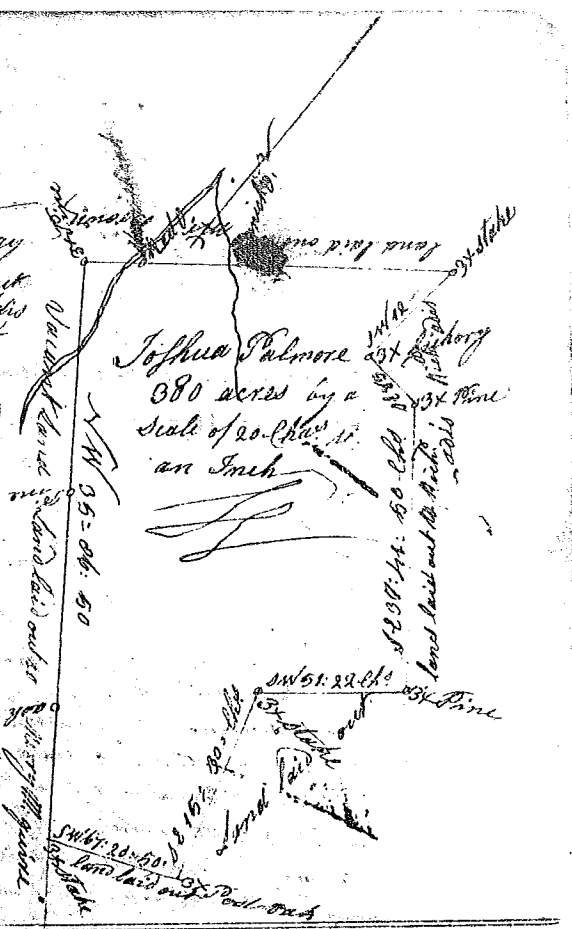

State of South Carolina,

Pursuant to a warrant from John Thomas Esq^r Commissioner of Locations I have admeasured and laid out unto John Chandler a tract of two hundred and seven acres of Land situate in 96th District on the south side of Snows River Bounding NE on land unknown NW on the widow Hay 1/2th on land laid out to Callimicus and hath such shape and Marks as the above Plat represents. Surveyed the 23rd Sept^r 1784

Recorded the 6th Dec^r 1784

Deliver Elisha Hunt

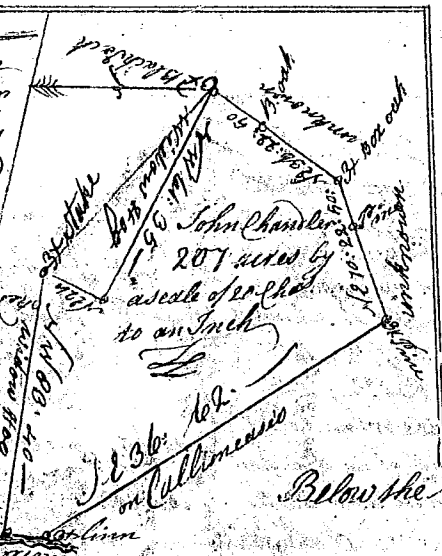

State of South Carolina, Ninety six district, Pursuant to a warrant from John Thomas Esq^r Commissioner of Locations I have admeasured and laid out unto Sedituhan Porter a tract of two hundred acres of Land situate ninety six district on the waters of Broad River Bounding NE & SE on lands belonging to Esq^r Pinkney the other sides on vacant lands and hath such shape and Marks as the annexed Plat represents. Surveyed 18th of Aug^t 1784

Recorded 6th day Dec^r 1784

David Hopkins Esq

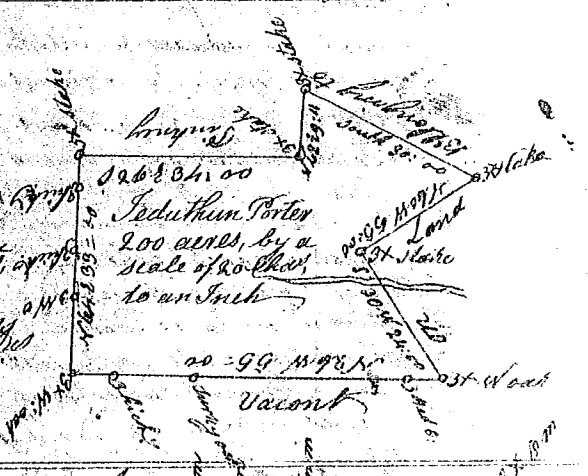

State of S^c Carolina

Pursuant to a warrant from John Thomas Esq^r Commissioner of Locations dated the 16th day of Sept^r 1784 I have admeasured and laid out unto Joshua Seaton a lot or tract of Land containing 200 acres situate in 96th district on a Branch of Hayburns Creek called Bearcove Creek below the former boundary line. Bounding NE on land laid out on the boundary with the widow Waltham on land unknown NE on Peter Cunningshams land & hath such shape & marks as the annexed Plat represents. Surveyed the 29th of Nov^r 1784

Recorded the 6th Dec^r 1784

Deliver Call^r Seaton

